

(0,635 mm) .025"

QMS-RF, QFS-RF SERIES

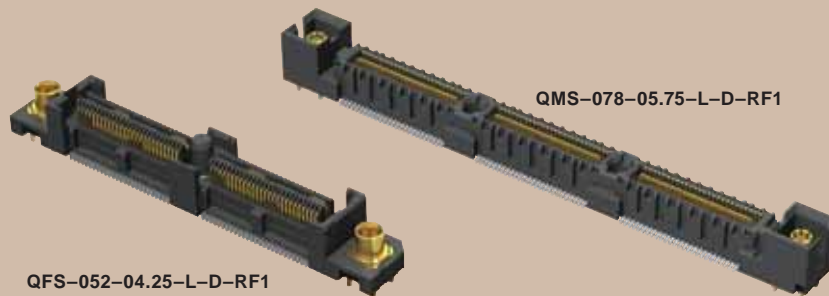

# HIGH SPEED COMBO RF

**Board Mates:**  
QMS-RF, QFS-RF

## SPECIFICATIONS

For complete specifications and recommended PCB layouts see [www.samtec.com?QMS](http://www.samtec.com?QMS) or [www.samtec.com?QFS](http://www.samtec.com?QFS)

### Insulator Material:

Liquid Crystal Polymer

### Contact, Terminal & Ground Plane Material:

Phosphor Bronze

### Plating:

Au over 50µ" (1,27 µm) Ni (Tin on Ground Plane Tail)

### Voltage Rating:

300 VAC mated with QMS/QFS

### Operating Temp:

-55°C to +125°C

### RoHS Compliant:

Yes

### Processing:

Lead-Free Solderable:

Yes

### SMT Lead Coplanarity:

(0,10 mm) .004" max (026-078)

### Board Stacking:

For applications requiring more than two connectors per board, contact [ipg@samtec.com](mailto:ipg@samtec.com)

## RECOGNITIONS

For complete scope of recognitions see [www.samtec.com/quality](http://www.samtec.com/quality)



FILE NO. E111594

## ALSO AVAILABLE (MOQ Required)

- Differential Pairs
  - Retention Pins
  - 2 RF Connectors/End
  - Hot Pluggable
- Contact Samtec.

## APPLICATIONS



See SO Series for precision machined standoffs.

**Note:** Some lengths, styles and options are non-standard, non-returnable.

QMS	NO. OF PINS PER ROW	LEAD STYLE	PLATING OPTION	D	END OPTION
	-026, -052, -078 (52 total pins per bank)	-05.75 =05.75 mm	-L = 10µ" (0,25 µm) Gold on Signal Pins and Ground Plane (Tin on Signal Pin tails, and Ground Plane tails)		-RF1 = One RF Plug per End

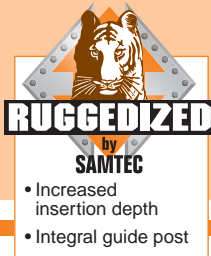
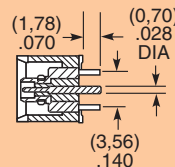
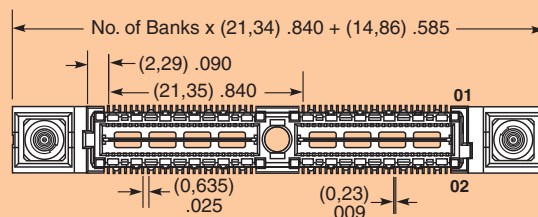

- Increased insertion depth
- Integral guide post



## APPLICATION

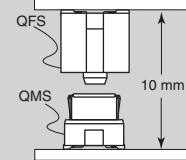

QFS	NO. OF PINS PER ROW	LEAD STYLE	PLATING OPTION	D	END OPTION
	-026, -052, -078 (52 total pins per bank)	-04.25 =04.25 mm	-L = 10µ" (0,25 µm) Gold on Signal Pins and Ground Plane (Tin on Signal Pin tails, and Ground Plane tails)		-RF1 = One RF Jack per End

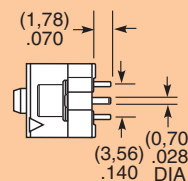
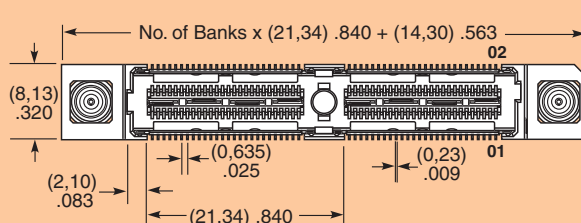

Due to technical progress, all designs, specifications and components are subject to change without notice.

[WWW.SAMTEC.COM](http://WWW.SAMTEC.COM)

SAMTEC USA • Tel: +1-800-SAMTEC-9 or +1-812-944-6733 SAMTEC NORTHERN CALIFORNIA • Tel: +1-408-395-5900 SAMTEC SOUTHERN CALIFORNIA • Tel: +1-800-726-8329  
 SAMTEC SOUTH AMERICA • Tel: +55 31 3786 3227 SAMTEC UNITED KINGDOM • Tel: +44 01236 739292 SAMTEC GERMANY • Tel: +49 (0) 89 / 89460-0  
 SAMTEC FRANCE • Tel: +33 1 60 95 06 60 SAMTEC ITALY • Tel: +39 039 6890337 SAMTEC NORDIC/BALTIC • Tel: +46 8 4477280 SAMTEC BENELUX • Tel: +44 01236 739292  
 SAMTEC ISRAEL • Tel: +972 3 7526600 SAMTEC INDIA • Tel: +91 80 3272 1612 SAMTEC ANZ • Tel: +613 9580 0683 SAMTEC SINGAPORE • Tel: +65 6745 5955 SAMTEC JAPAN • Tel: +81 45 475 1385  
 SAMTEC SHANGHAI • Tel: +86 21 6083 3766 SAMTEC SHENZHEN • Tel: +86 755 83776780 SAMTEC TAIWAN • Tel: +886 2 2735 6109 SAMTEC HONG KONG • Tel: +852 26904658 SAMTEC KOREA • Tel: +82 31 717 5685