

SPECIFICATIONS

RoHS Compliant



Part Number: 032526
Model Number: MS24B3

SPEC Number: 26016815A
April 20, 2012

Mechanical Drawing:

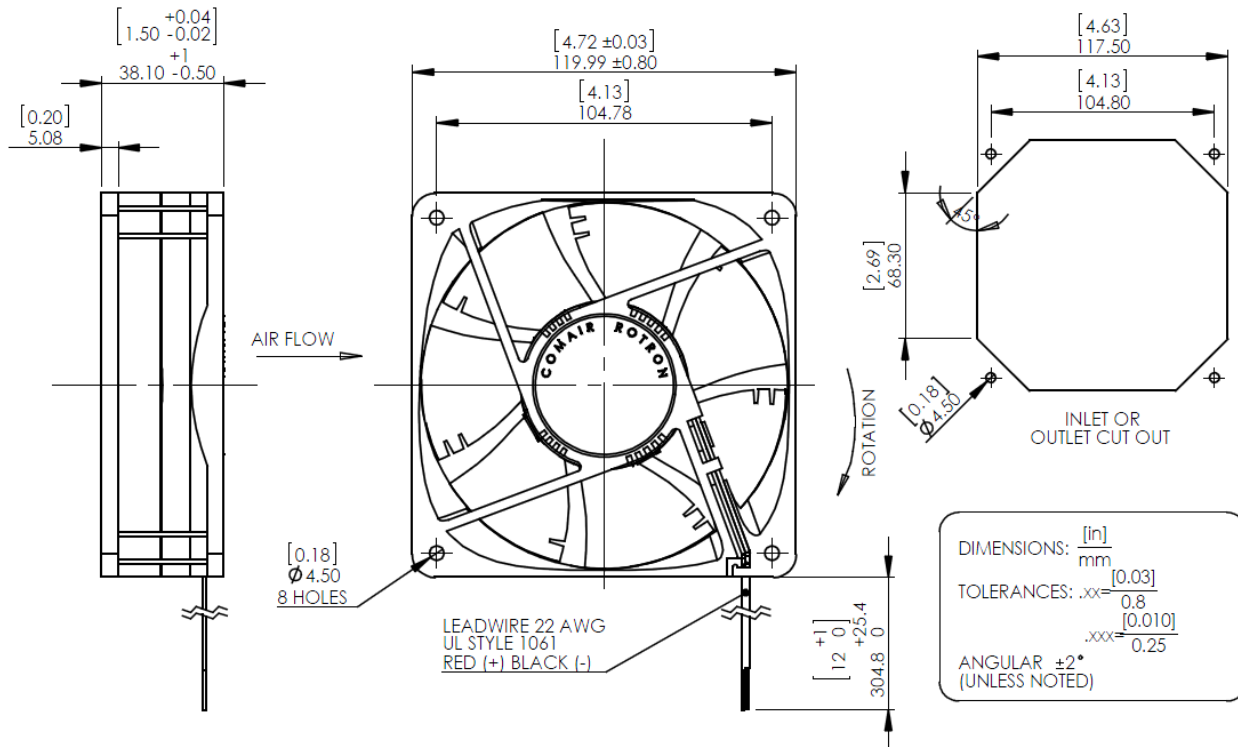

Motor:

Nominal Voltage	= 24 vdc
Operating Voltage Range	= 12 - 28 vdc
Nominal Running Current	= 0.290 amps
Max. Locked Rotor Current	= 0.730 amps
Running Power	= 7.0 watts
Average Speed	= 2900 RPM
Bearings	= Ball
Air Flow	= 110 CFM
Acoustics	= 49.1 dBA

Construction:

Venturi: Plastic, Black, UL 94V-0.
Propeller: Plastic, Black, UL 94V-0

Life Expectancy:

This fan is designed for continuous duty life of 85,000 hours at 40°C.

Additional Features:

Brushless DC Motor
Polarity Protected
Automatic Reset Capability
Locked Rotor Protection
Operating Temperature: -10°C to 70°C
Storage Temperature: -40°C to 85°C

Termination:

12" Lead wires, 22 AWG, UL 1061
Red = Power (+)
Black = Ground (-)

Agency Approvals:

UL, CUL