

# POWER MODUL INPUT CONNECTOR

Plug connector – Solder pin – Straight – Precision machined contacts – Through hole solder type

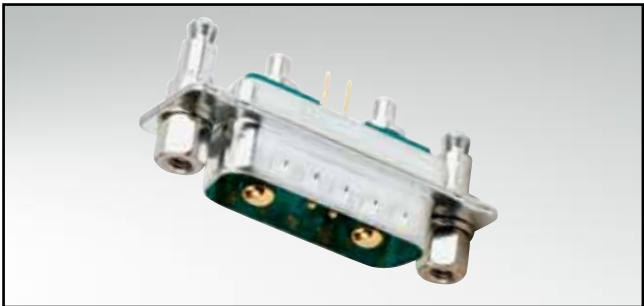

RoHS compliant

## DESCRIPTION

- 7W2 Combination D-SUB Connectors
- Design: 2 power contacts 24 A / 2 signal contacts
- Mounting styles:
  - 4-40 UNC threaded rear spacer with PCB clip,
  - 4-40 UNC threaded insert
  - 4-40 UNC threaded rear spacer with PCB clip,
  - 4-40 UNC hex bolt
- Note for 9W4 product please contact factory

## PRODUCT DRAWING

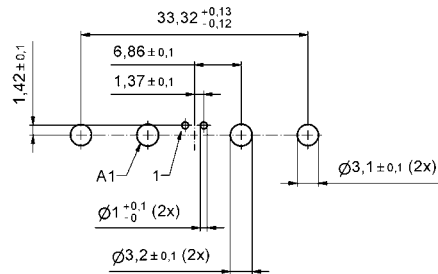
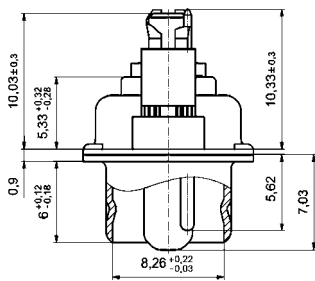
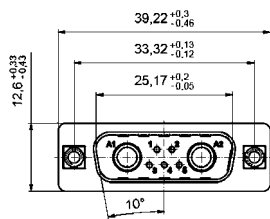

Mounting style:  
4-40 UNC threaded rear spacer with PCB clip,  
4-40 UNC threaded insert

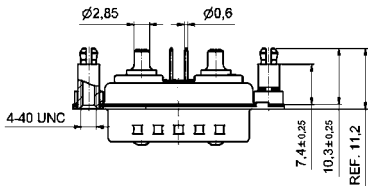

Mounting style:  
4-40 UNC threaded rear spacer with PCB clip,  
4-40 UNC hex bolt

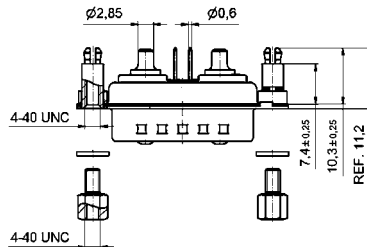

## ORDER DATA

| PLUG CONNECTOR |  |             |
|----------------|--|-------------|
| Design         | Mounting style 4-40 UNC                            | Part Number |
| 7W2            | Threaded rear spacer with PCB clip/Hex bolt        | 13-000111   |
| 7W2            | Threaded rear spacer with PCB clip/Threaded insert | 13-000121   |

PCB clip .122" / 3.1 ± .004" / 0.10 mm hole diameter