



E-SWITCH®

SERIES TL 3301 SWITCHES

TACT SWITCHES SMT - 6mm x 6mm



FEATURES & BENEFITS

- ▶ SMT Design
- ▶ Compatible with lead-free soldering

APPLICATIONS/MARKETS

- ▶ Telecommunications
- ▶ Consumer Electronics
- ▶ Audio/visual
- ▶ Medical
- ▶ Testing/instrumentation
- ▶ Computer/servers/peripherals

SPECIFICATIONS

Contact Rating:	50mA @ 12 VDC
Life Expectancy:	100,000 cycles typical
Contact Resistance:	100mΩ max. initial @ 2-4 VDC 100mA for both silver and gold plated contacts
Insulation Resistance:	100MΩ min.
Dielectric Strength:	250 VAC
Actuation Force:	100 ± 50 gf, 160 ± 50 gf, 260 ± 50 gf
Operating Temperature:	-20°C to 70°C
Travel:	0.25 Typ

MATERIALS

Housing:	PPS or Nylon
Actuator:	PPS or Nylon
Bracket/Cover:	Tin plated steel
Contacts:	Gold or silver plated phosphor bronze
Terminals:	Gold or silver plated brass

HOW TO ORDER

SERIES	MODEL NO.	ACTUATOR* ("L" Dimension)	OPERATING FORCE	CONTACT MATERIAL	TERMINATION
TL	3301	T = 2.4mm <input type="checkbox"/> SP = 2.8mm <input type="checkbox"/> N = 4.3mm A = 5.0mm E = 7.3mm F = 7.0mm C = 8.0mm P = 8.5mm B = 9.5mm D = 13.0mm	F100 F160 F260	Q = Silver R = Gold	G = Gull Wing J = J-Lead

☐ - Square Snap-on Actuator Head
"L" Dimension is 7.5mm

* Note: Not all actuator lengths
available with tape and reel
packaging. Please contact
E-Switch to confirm availability.

Example Ordering Number

TL-3301-N-F160-Q-J

Specifications subject to change without notice.

TACT
SWITCHESNAVIGATION
SWITCHESPUSHBUTTON
SWITCHESTOGGLE
SWITCHESROCKER
SWITCHESSLIDE
SWITCHESSNAP-ACTION
SWITCHESDIP
SWITCHESKEYLOCK
SWITCHESROTARY
SWITCHESDETECTOR
SWITCHESCAP
OPTIONS



SERIES TL 3301 SWITCHES

TACT SWITCHES SMT - 6mm x 6mm

TACT
SWITCHES

NAVIGATION
SWITCHES

PUSHBUTTON
SWITCHES

TOGGLE
SWITCHES

ROCKER
SWITCHES

SLIDE
SWITCHES

SNAP-ACTION
SWITCHES

DIP
SWITCHES

KEYLOCK
SWITCHES

ROTARY
SWITCHES

DETECTOR
SWITCHES

CAP.
OPTIONS

TL 3301

GULL WING
TERMINATION

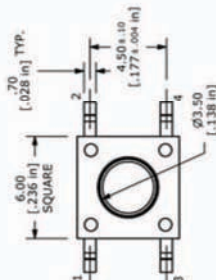
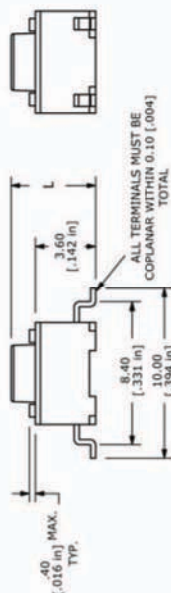

SCHEMATIC

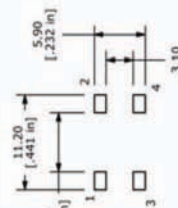

P.C. MOUNTING

TL 3301

J-LEAD
TERMINATION

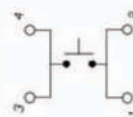
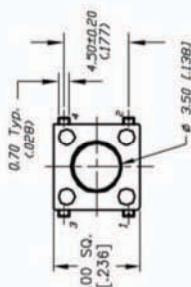
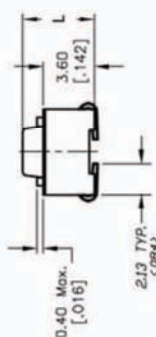

SCHEMATIC

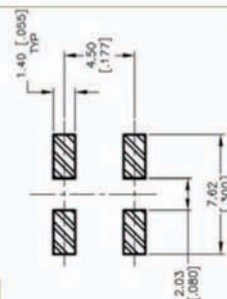

P.C. MOUNTING