



SSF212X100-14G

Compact Horizontal Stainless Steel Floatswitch
1/2" NPT External Fitting



- **Stainless Steel**
- **External Mount (1/2" NPT)**
- **N/O or N/C switching action**
- **Operating Temp up to 120°C**
- **G1/4 thread for attaching junction box**

The SSF212 series are externally mounted float switches via 1/2NPT thread. This particular version has a G1/4 thread at the cable entry to enable attachment of a suitable junction box.

The switches can be fitted to a tank without requiring access to the inside of the tank, as they are screwed in from the outside.

The float switch can be fitted to achieve either N/O (make on rise) or N/C (make on fall) switching action by simply rotating through 180° when fitting.

Technical Specification

Mounting style	External	Cable length - standard	100cm
Mounting thread	1/2" NPT	Cable size	17/0.10 - AWG22
Float/Stem material	316/304 grade	Cable conductor material	Tinned copper
Maximum Temperature	120 °C	Cable sheath material	XLPE
Maximum Pressure	10 bar	Cable temperature rating	125 °C
Float SG	0.7	Sealing gasket	N/A
Minimum Fluid SG	0.75	Tightening torque for fixing	2.0kg/cm

Electrical Specification

Contact Form	N/O or N/C	
Switching Power Max.	VA	50
Switching Current Max.	A	0.5
Switching Voltage Max AC	V	300
Switching Voltage Max DC	V	350

All ratings are for resistive load only.

Cynergy3 Part

SSF212X100-14G

Leadouts

100cm XLPE wires

Mechanical Dimensions (mm)

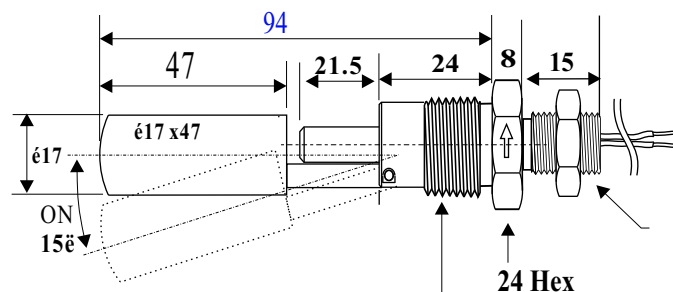

Cynergy3 Components Ltd.
 7 Cobham Road
 Ferndown Industrial Estate
 Wimborne, Dorset BH21 7PE
 Telephone +44 (0) 1202 897969

Email:sales@cynergy3.com

ISO 9001CERTIFIED

www.cynergy3.com

© 2011 Cynergy3 Components, All Rights Reserved. Specifications are subject to change without prior notice. Cynergy3 Components and the Cynergy3 Components logo are trademarks of Cynergy3 Components Limited.