

DO NOT
SCALE FROM
THIS PRINT

C5

.0033^{+0.0040}_{-.0020} [0.084^{+0.102}_{-0.051}]
(SEE NOTES 9 & 10)

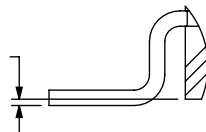

DETAIL 'A'
SCALE 10:1

SIB-1XX-XX-XX-S-XX-XX

NO OF POSITIONS
-02 THRU -30
(PER ROW)

LEAD STYLE
-02: SURFACE MOUNT
(USE C-228-X)

PLATING SPECIFICATION
-F: FLASH SELECTIVE
(USE C-228-F)
-FM: FLASH SELECTIVE, PURE TIN,
MATTE FINISH
(USE C-228-F)

THREADED INSERT OPTION
[NOT AVAILABLE ON 30 POS]
* -E: TI-2-56-115 (ENGLISH)
* -M: TI-M2-4-115-N (METRIC)
(SEE FIG. 2, SHEET 2)
* -TI: NO INSERTS PLACED IN BODY
(SEE TABLE 1 ON SHEET 2 FOR
-TI POSITIONAL OFFERINGS)

OPTION
-LC: LOCKING CLIPS
(USE LC-09-TM) (SEE NOTE 13)
[N/A WITH THREADED INSERT OPTION
-E, -M OR -TI]

ROW SPECIFICATION
-S: SINGLE (USE SIBM-XX-02-S)

* AVAILABLE TO EXISTING CUSTOMERS ONLY

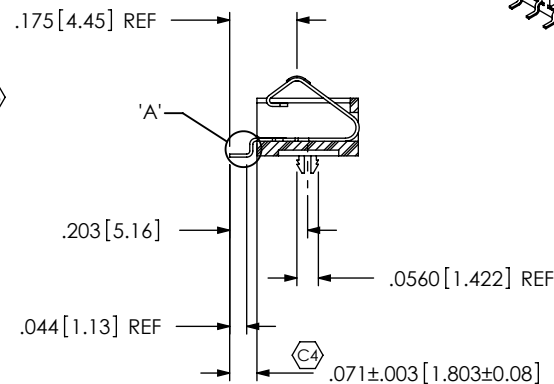
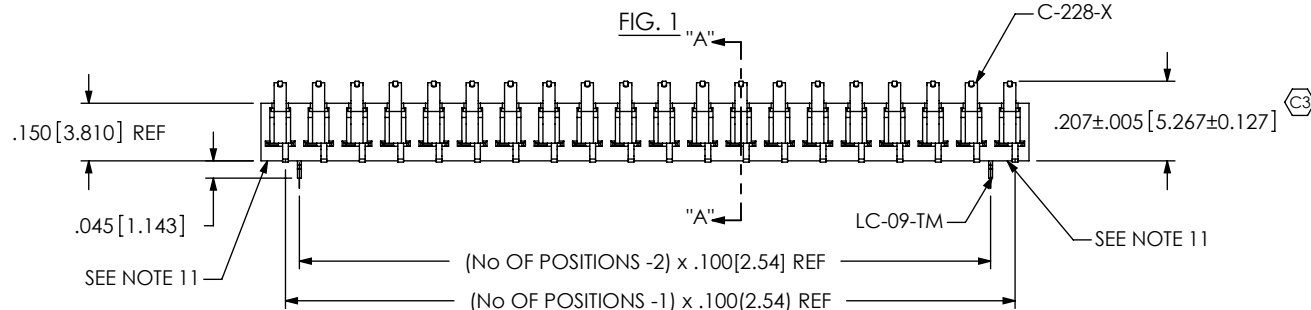
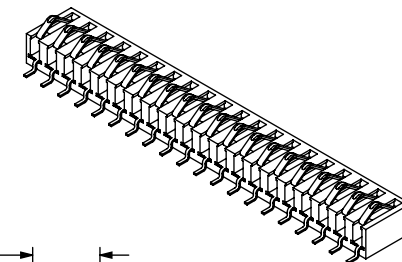
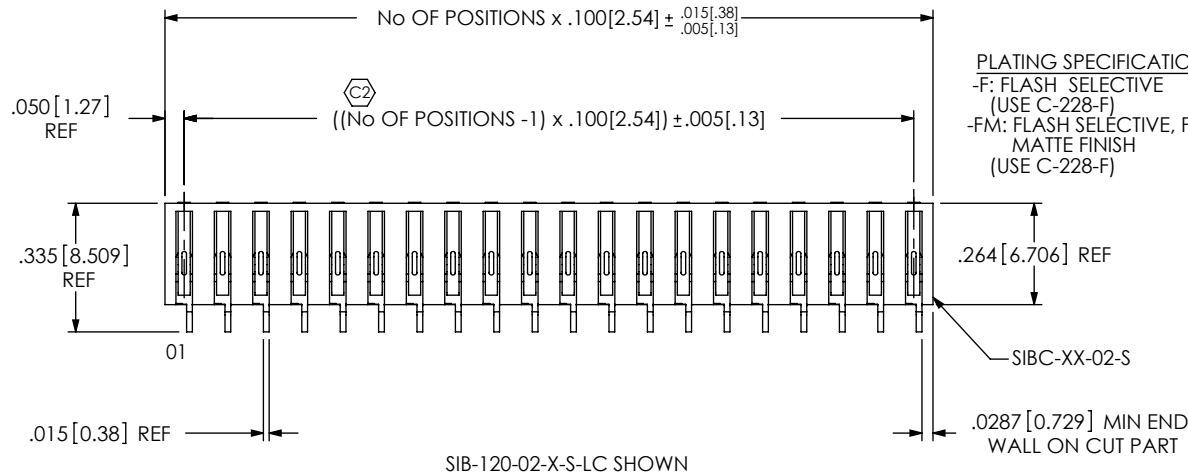

SECTION "A"-A"

NOTES:

1. (C) REPRESENTS A CRITICAL DIMENSION.
2. COPLANARITY: SEE TABLE 2.
3. BURR ALLOWANCE: .0015[.038] MAX.
4. MAXIMUM CUT FLASH: .010[.3], CAN NOT EXTEND PAST TAIL.
5. MINIMUM PUSHOUT FORCE: 1 LB.
6. MAXIMUM ALLOWABLE BOW: .004[.10] INCH/INCH AFTER ASSEMBLY.
7. THREADED INSERT MUST HANDLE 25 IN-OZ OF TORQUE WITHOUT
ROTATING OR LOOSENING.
8. THREADED INSERT RETENTION: 10 LBS. MINIMUM.
9. MAX VARIATION FROM PIN TO PIN TO BE .002.
10. MEASURED ON UNCUT PARTS.
11. END FEET CAN BE NO MORE THAN .002 BELOW BOTTOM OF TAILS.
12. FINISHED GOOD WITH AND WITHOUT FEET IS ACCEPTABLE. SEE SHEET 3 FOR
FINISHED GOOD WITH FEET.
13. DUE TO THE HIGH AMOUNT OF INSERTION FORCE NEEDED, THE -LC OPTION
IS NOT COMPATIBLE WITH AUTO PLACEMENT. SAMTEC RECOMMENDS
MANUAL PLACEMENT FOR ALL ASSEMBLIES WITH THE -LC OPTION.

TABLE 2: COPLANARITY	
POSITIONS	"A"
-02 THRU -19	.004[.10]
-20 THRU -30	.006[.15]

UNLESS OTHERWISE SPECIFIED,
DIMENSIONS ARE IN INCHES.

TOLERANCES ARE:

DECIMALS ANGLES
.XX: ±.01 [.3] 2°
.XXX: ±.005 [.13]
.XXXX: ±.0020 [.051]

PROPRIETARY NOTE

THIS DOCUMENT CONTAINS INFORMATION
CONFIDENTIAL AND PROPRIETARY TO
SAMTEC, INC. AND SHALL NOT BE REPRODUCED
OR TRANSFERRED TO OTHER DOCUMENTS OR
DISCLOSED TO OTHERS OR USED FOR ANY
PURPOSE OTHER THAN THAT WHICH IT WAS
OBTAINED WITHOUT THE EXPRESSED WRITTEN
CONSENT OF SAMTEC, INC.

MATERIAL: DO NOT SCALE DRAWING

INSULATOR: LCP, COLOR: BLACK
CONTACT: PHOSPHOR BRONZE

SHEET SCALE: 2:1

DESCRIPTION:

.100 SINGLE INTERFACE BEAM ASSEMBLY

DWG. NO.

SIB-1XX-XX-XX-S-XX-XX

BY: DEAN P

9/20/2000

SHEET 1 OF 3

FIG. 2
SIB-120-02-X-S-E SHOWN

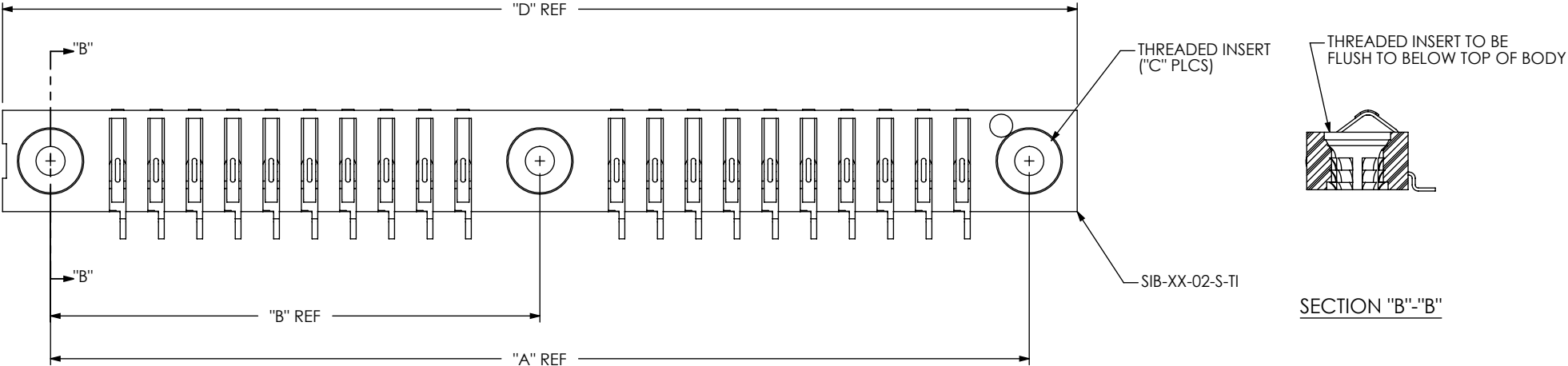
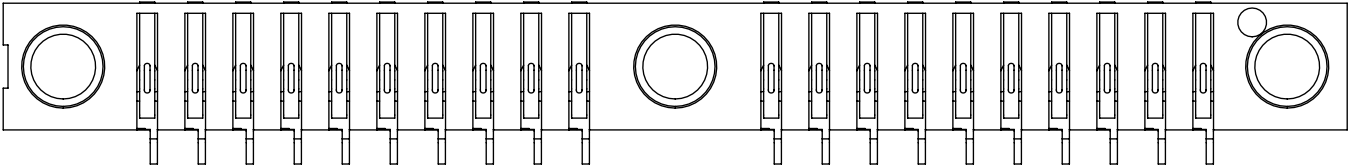
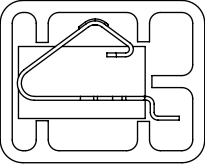

FIG. 3
SIB-120-02-X-S-TI SHOWN



PACKAGING VIEW
(PARTS TO HAVE POSITION #1 LOADED IN
SAME DIRECTION AS ARROW ON TUBE)

NO -LC OPTION



TUBE: PT-1-24-01-118
PLUG: TP-03

-LC OPTION

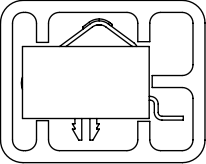

TUBE: PT-1-24-01-118
PLUG: TP-03

TABLE 1: THREADED INSERT OPTION				
POS	"A"	"B"	"C"	"D"
-05	.750[19.05]	N/A	2	1.000[25.40]
-10	1.250[31.75]	N/A	2	1.500[38.10]
-15	1.750[44.45]	N/A	2	2.000[50.80]
-20	2.550[64.77]	1.275[32.39]	3	2.800[71.12]
-25	3.050[77.47]	1.475[37.47]	3	3.300[83.82]

F:\DWG\MISC\MKTG\SIB-1XX-XX-XX-XX-MKT.SLDDRW

PROPRIETARY NOTE
THIS DOCUMENT CONTAINS INFORMATION
CONFIDENTIAL AND PROPRIETARY TO
SAMTEC, INC. AND SHALL NOT BE REPRODUCED
OR TRANSFERRED TO OTHER DOCUMENTS OR
DISCLOSED TO OTHERS OR USED FOR ANY
PURPOSE OTHER THAN THAT WHICH IT WAS
OBTAINED WITHOUT THE EXPRESSED WRITTEN
CONSENT OF SAMTEC, INC.

DO NOT SCALE DRAWING

SHEET SCALE: 2.5:1

520 PARK EAST BLVD, NEW ALBANY, IN 47150
PHONE: 812-944-6733 FAX: 812-948-5047
e-Mail info@SAMTEC.com code 55322

DESCRIPTION:
.100 SINGLE INTERFACE BEAM ASSEMBLY

DWG. NO.
SIB-1XX-XX-XX-S-XX-XX

BY: DEAN P 9/20/2000 SHEET 2 OF 3

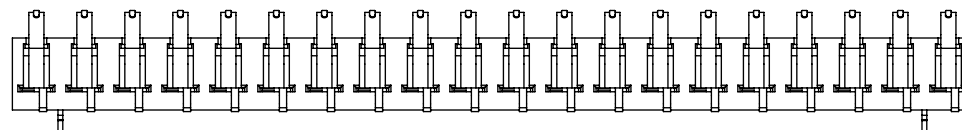
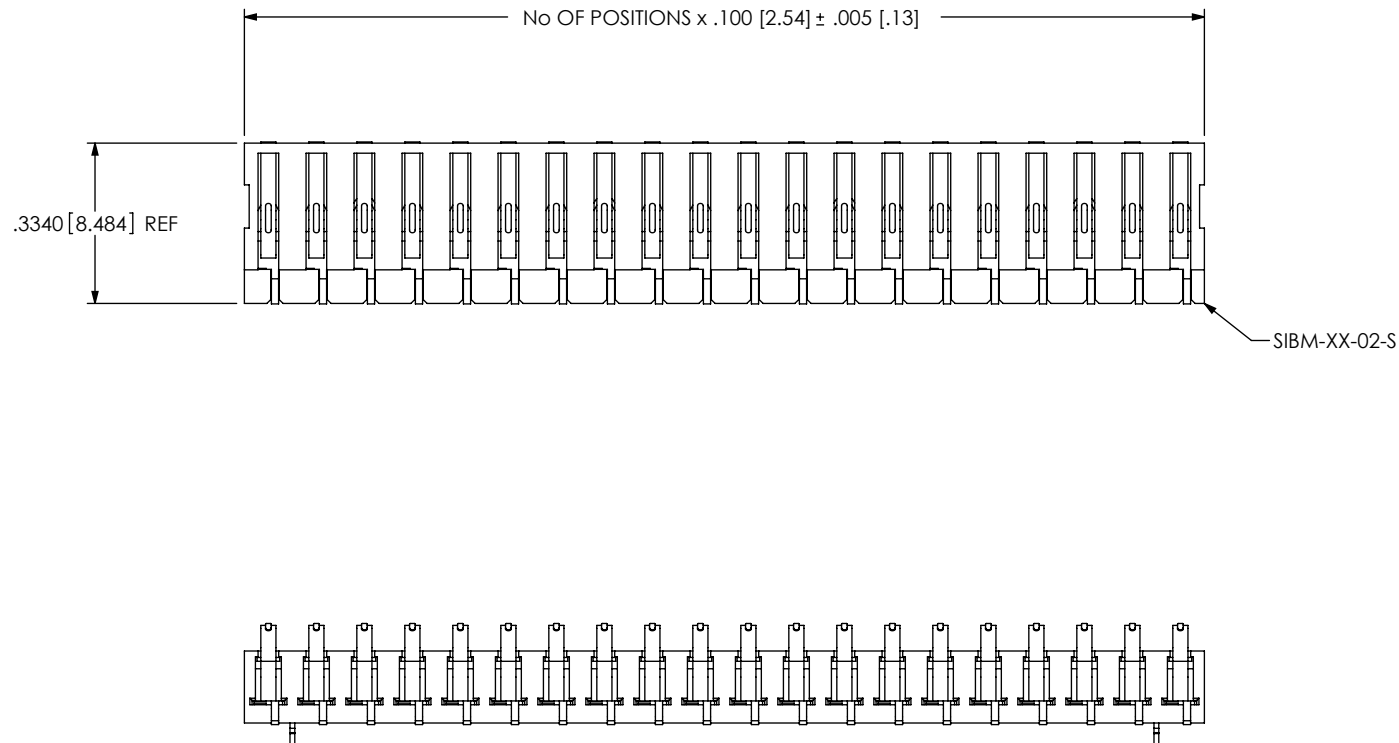

FIG. 3
SAME AS FIG1 EXCEPT AS SHOWN

PROPRIETARY NOTE
THIS DOCUMENT CONTAINS INFORMATION
CONFIDENTIAL AND PROPRIETARY TO
SAMTEC, INC. AND SHALL NOT BE REPRODUCED
OR TRANSFERRED TO OTHER DOCUMENTS OR
DISCLOSED TO OTHERS OR USED FOR ANY
PURPOSE OTHER THAN THAT WHICH IT WAS
OBTAINED WITHOUT THE EXPRESSED WRITTEN
CONSENT OF SAMTEC, INC.

DO NOT SCALE DRAWING

SHEET SCALE: 2.5:1

samtec
520 PARK EAST BLVD, NEW ALBANY, IN 47150
PHONE: 812-944-6733 FAX: 812-948-5047
e-Mail info@SAMTEC.com code 55322

DESCRIPTION:
.100 SINGLE INTERFACE BEAM ASSEMBLY

DWG. NO. SIB-1XX-XX-XX-S-XX-XX

BY: DEAN P 9/20/2000 SHEET 3 OF 3