

DO NOT
SCALE FROM
THIS PRINT

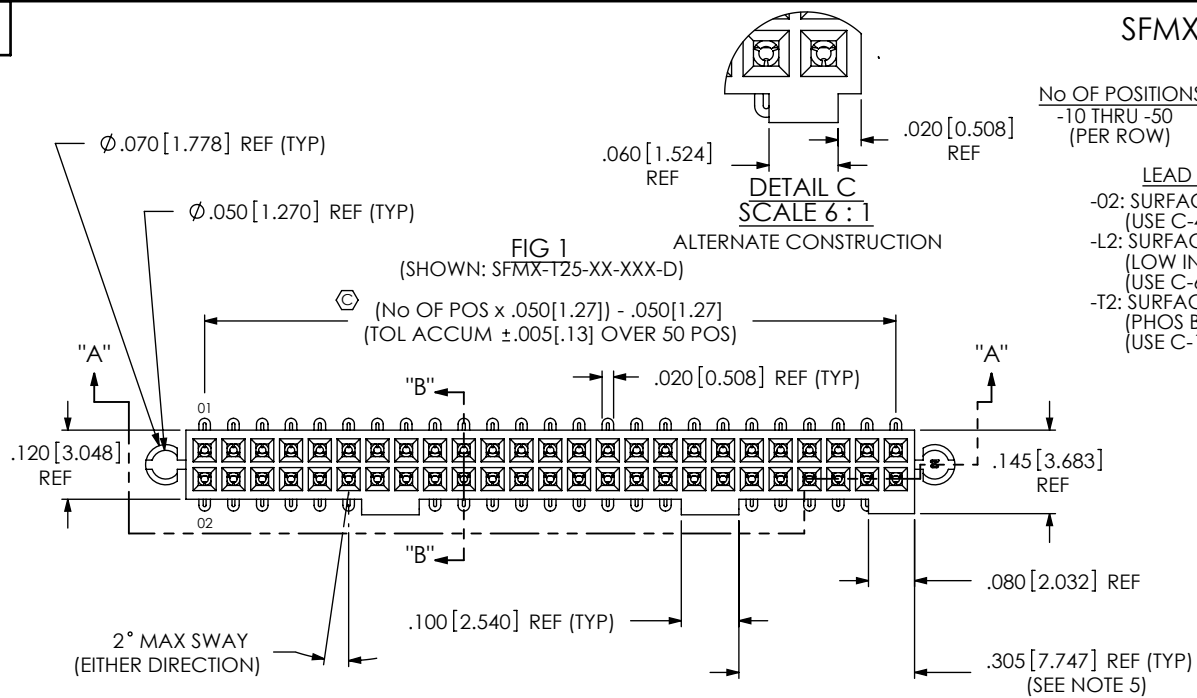

SFMX-1XX-XX-XXX-D-XX

OPTIONS

-TR: TAPE & REEL PACKAGING
(SEE FIG 2, SHT 2)
-K: POLYAMIDE FILM PAD (.005
THICKNESS WITH SILICONE ADHESIVE)
(USE K-500-300)(SEE FIG 3, SHT 2)

– ROW SPECIFICATION

-D: DOUBLE ROW
(USE SFMX-XX-D-X)

– PLATING SPECIFICATION

- S: SELECTIVE
- P: GOLD FLASHED PALLADIUM NICKEL
- F: FLASH SELECTIVE GOLD
- H: HEAVY GOLD
- L: LIGHT SELECTIVE GOLD
- STL: SELECTIVE GOLD/ TIN-LEAD TAIL
(ONLY AVAILABLE ON -02 & -L2 LEADSTYLES)
- SM: SELECTIVE, MATTE TIN TAIL
- FM: FLASH SELECTIVE, MATTE TIN TAIL
- LM: LIGHT SELECTIVE, MATTE TIN TAIL

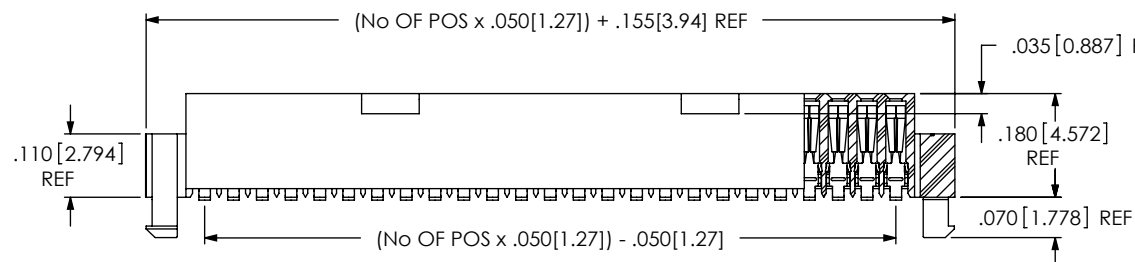
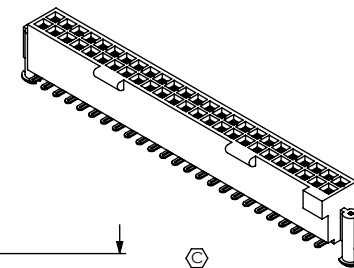

SECTION "A"-"A"

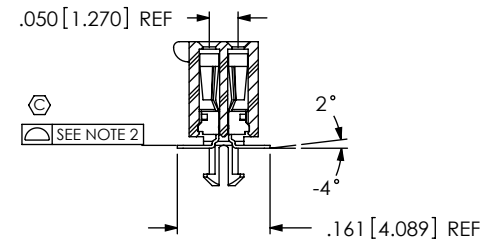
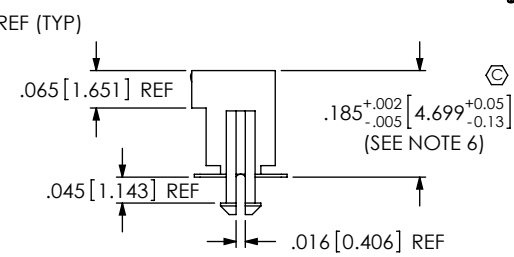
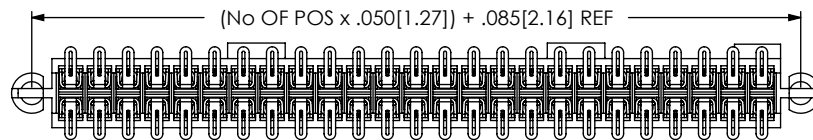

SECTION "B"- "B"

NOTES:

1.  REPRESENTS A CRITICAL DIMENSION.
2. COPLANARITY: .004 [.10] FOR POS. 10 THRU 26
.006 [.15] FOR POS. 27 THRU 50
3. MINIMUM PUSHOUT FORCE: .5 LB.
4. MAXIMUM ALLOWABLE BOW: .002 INCH/INCH AFTER ASSEMBLY.
5. POSITIONS -10 THROUGH -34 WILL HAVE ONLY ONE CLIP AT DIMENSION SHOWN;
POSITIONS -25 THROUGH -24 WILL HAVE TWO CLIPS AT DIMENSION SHOWN;
POSITIONS -35 THROUGH -50 WILL HAVE THREE CLIPS: TWO AT DIMENSION SHOWN &
ONE CENTERED ON INSULATOR.
6. MAX HEIGHT VARIATION BETWEEN ANY TWO PINS TO BE .003 [.08].

UNLESS OTHERWISE SPECIFIED,
DIMENSIONS ARE IN INCHES.
TOLERANCES ARE:

DECIMALS	ANGLES
.XX: $\pm .01[.3]$	2°
.XXX: $\pm .005[.13]$	
.XXXX: $\pm .0020[.051]$	

PROPRIETARY NOTE

THIS DOCUMENT CONTAINS INFORMATION
CONFIDENTIAL AND PROPRIETARY TO
SAMTEC, INC. AND SHALL NOT BE REPRODUCED
OR TRANSFERRED TO OTHER DOCUMENTS OR
DISCLOSED TO OTHERS OR USED FOR ANY
PURPOSE OTHER THAN THAT WHICH IT WAS
OBTAINED WITHOUT THE EXPRESSED WRITTEN
CONSENT OF SAMTEC, INC.

MATERIAL:

INSULATOR: VECTRA E130
CONTACT: BeCu
PHOS BRONZE

F:\DWG\MISC\MKTG\SFMX-1XX-XX-XXX-D-XX-MKT.SLDDRW

DO NOT SCALE DRAWING

SHEET SCALE: 3:1

DESCRIPTION:

.050[1.27] x .050[1.27] LOCKING SOCKET ASSEMBLY

DWG. NO.

SFMX-1XX-XX-XXX-D-XX

BY: BRATCHER 2/4/99

SHEET 1 OF 2



520 PARK EAST BLVD, NEW ALBANY, IN 47150
PHONE: 812-944-6733 FAX: 812-948-5047
e-Mail: info@SAMTEC.com code: 55322

FIG 2
-K: POLYAMIDE FILM PAD OPTION
(SHOWN: SFMX-110-XX-XXX-D-K)

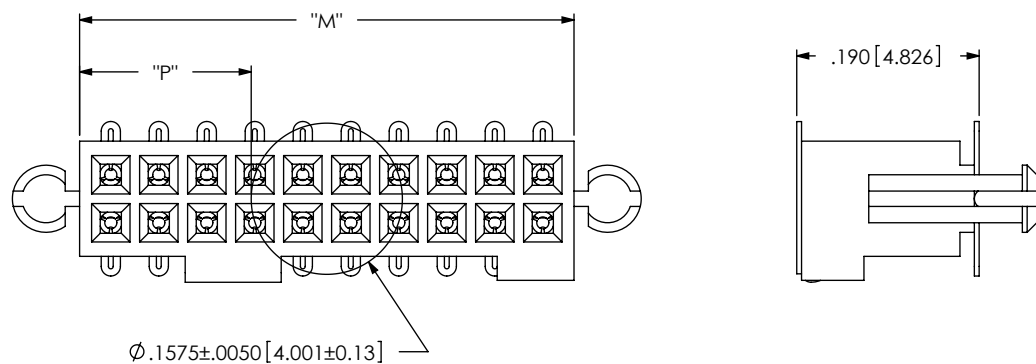

NOTE:
"M" = USED MEASURED DIMENSION (REF)
"P" = $\{("M" - .1575[4.000]) / 2\} \pm .020[.51]$

PACKAGING VIEW

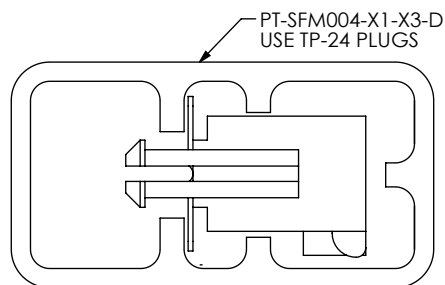

NOTE:
1. NOTE DELETED.
2. LOAD PARTS WITH NOTCH TOWARDS ARROW.

CRITICAL DIMENSION INSPECTION INSTRUCTION TABLE	
ASSEMBLY OPERATION	IN PROCESS INSPECTION
FILL	C1, C2, C3

FIG 3
-TR: TAPE & REEL PACKAGING

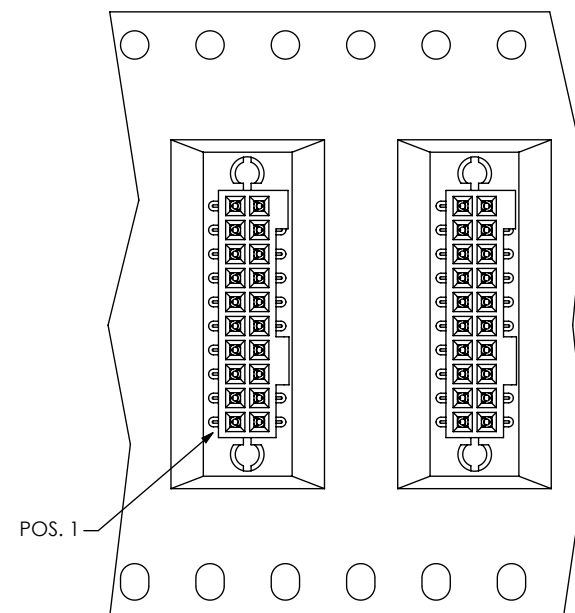

UNWINDING DIRECTION →

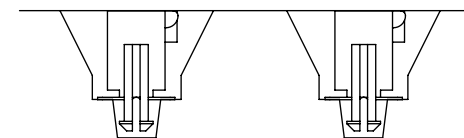

F:\DWG\MISC\MKTG\SMX-1XX-XX-XXX-D-XX-MKT.SLDDRW

PROPRIETARY NOTE

THIS DOCUMENT CONTAINS INFORMATION CONFIDENTIAL AND PROPRIETARY TO SAMTEC, INC. AND SHALL NOT BE REPRODUCED OR TRANSFERRED TO OTHER DOCUMENTS OR DISCLOSED TO OTHERS OR USED FOR ANY PURPOSE OTHER THAN THAT WHICH IT WAS OBTAINED WITHOUT THE EXPRESSED WRITTEN CONSENT OF SAMTEC, INC.

DO NOT SCALE DRAWING

SHEET SCALE: 5:1

samtec

520 PARK EAST BLVD, NEW ALBANY, IN 47150
PHONE: 812-944-6733 FAX: 812-948-5047
e-Mail: info@SAMTEC.com code: 55322

DESCRIPTION:
.050[1.27] x .050[1.27] LOCKING SOCKET ASSEMBLY

DWG. NO.
SFMX-1XX-XX-XXX-D-XX

BY: BRATCHER 2/4/99

SHEET 2 OF 2