

SMD Power Inductors (NR series)

NR6028T150M

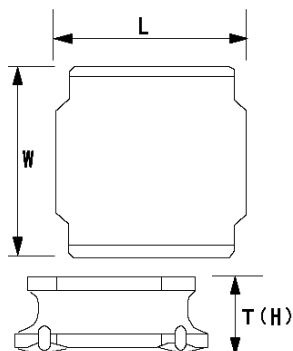

■ Features

- Item Summary
15 μ H ($\pm 20\%$), 1600mA, 1800mA
- Lifecycle Stage
Mass Production
- Standard packaging quantity (minimum)
Taping 2000pcs

■ Products characteristics table

CaseSize (EIA/JIS)	~/6028
Inductance	15 μ H ($\pm 20\%$)
Inductance Measuring Frequency	100kHz
Rated Current -Saturation Current	1600mA
Rated Current -Temperature Rise Current	1800mA
DC Resistance (max)	0.1235 Ω
Avg. of DC Resistance	0.095 Ω
Temperature Range	-25°C to 120°C
Self-resonant Frequency (min)	17MHz
RoHS Compliance	Yes
Halogen Free	Yes
Soldering Method	Reflow

■ External Dimensions

L	6mm ± 0.2
W	6mm ± 0.2
H	2.8mm max

■ Recommended Land Patterns

【推奨ランドパターン】

実装上の注意

- ・実装状態を確認の上ご使用くださいようお願いいたします。
- ・本製品のはんだ付けはリフローはんだ工法に限りします。

【Recommended Land Patterns】

Surface Mounting

- ・Mounting and soldering conditions should be checked beforehand.
- ・Applicable soldering process to these products is reflow soldering only.

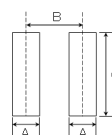

SMD Power Inductors (NR series/NR series H type/S type /V type)

Type	A	B	C
NRS601.0			
NR 601.2, NRS601.2			
NRS601.4			
NR 6020, NRS6020	1.6	4.7	5.7
NR 6028, NRS6028			
NR 6045, NRS6045			

unit: mm