

## SMD Power Inductors (NR series)

## NR5040T470M

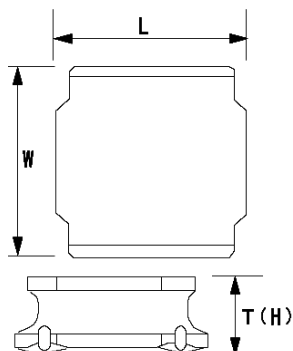

## ■ Features

- Item Summary  
47  $\mu$ H( $\pm 20\%$ ), 1100mA, 900mA
- Lifecycle Stage  
Mass Production
- Standard packaging quantity (minimum)  
Taping 1500pcs

## ■ Products characteristics table

CaseSize (EIA/JIS)	~/5040
Inductance	47 $\mu$ H( $\pm 20\%$ )
Inductance Measuring Frequency	100kHz
Rated Current -Saturation Current	1100mA
Rated Current -Temperature Rise Current	900mA
DC Resistance (max)	0.403 $\Omega$
Avg. of DC Resistance	0.31 $\Omega$
Temperature Range	-25°C to 120°C
Self-resonant Frequency (min)	6MHz
RoHS Compliance	Yes
Halogen Free	Yes
Soldering Method	Reflow

## ■ External Dimensions

L	4.9mm $\pm 0.2$
W	4.9mm $\pm 0.2$
H	4mm max

## ■ Recommended Land Patterns

【推奨ランドパターン】 実装上の注意 ・実装状態を確認の上ご使用ください。また、ご購入の際は、 本製品のほんたひはリフローはんだ工法に準じます。	
【Recommended Land Patterns】 Surface Mounting ・Mounting and soldering conditions should be checked beforehand. ・Applicable soldering process to these products is reflow soldering only.	

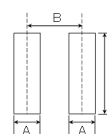

SMD Power Inductors (NR series/NR series H type/S type /V type)			
Type	A	B	C
NR5010,			
NR5012,			
NR5014,			
NR5020,	1.5	3.6	4
NR5024,			
NR5030,			
NR 5040, NR5040			

unit:mm