

SMD Power Inductors

NR10050T330M

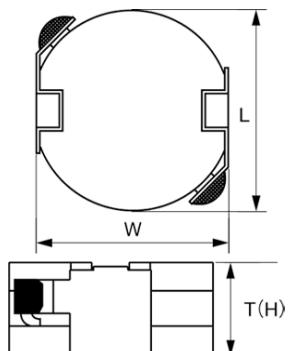

■ Features

- Item Summary
33 μ H($\pm 20\%$), 2500mA, 2100mA
- Lifecycle Stage
Mass Production
- Standard packaging quantity (minimum)
Taping 500pcs

■ Products characteristics table

CaseSize (EIA/JIS)	~/10050
Inductance	33 μ H($\pm 20\%$)
Inductance Measuring Frequency	100kHz
Rated Current -Saturation Current	2500mA
Rated Current -Temperature Rise Current	2100mA
DC Resistance (max)	0.0858 Ω
Avg. of DC.Resistance	0.066 Ω
Temperature Range	-25°C to 105°C
Self-resonant Frequency (min)	8.2MHz
RoHS Compliance	Yes
Halogen Free	Yes
Soldering Method	Reflow

■ External Dimensions

L	10mm ± 0.3
W	9.8mm ± 0.5
H	5mm max

■ Recommended Land Patterns

【推奨ランドパターン】
実装上の注意
・実装状態を確認の上ご使用ください。また、お買い上げの際は、本製品のハンダ付けはリフローハンダ工法に限りません。

【Recommended Land Patterns】
Surface Mounting
・Mounting and soldering conditions should be checked beforehand.
・Applicable soldering process to these products is reflow soldering only.

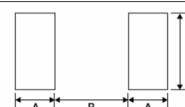

SMD Power Inductors			
Type	A	B	C
NR10050	2.6	5.4	4.5

unit: mm