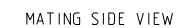
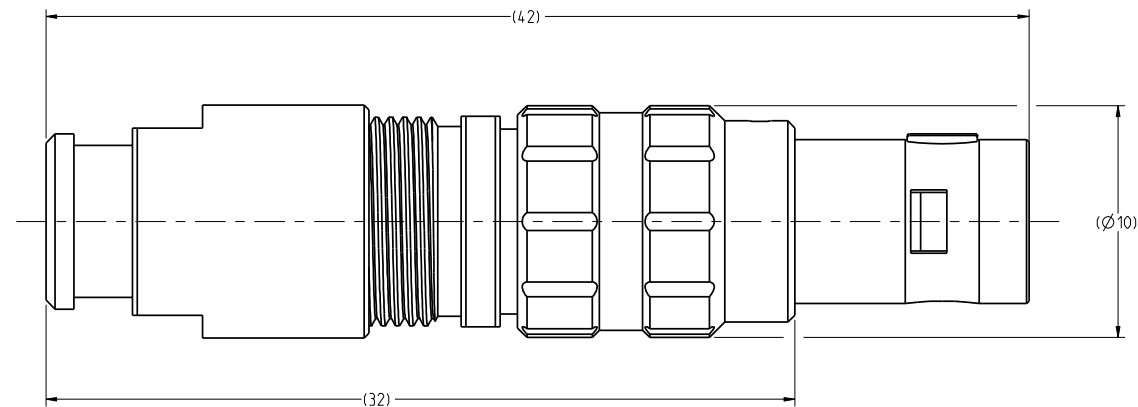

1

2 CONNECTOR WITH BACKNUT FOR PROTECTIVE BOOT - PROTECTIVE BOOT TO ORDER SEPARATELY.

1 OF 2

**A**

DWG. NO.  
**JBXFD0G02MCSDSMRC**

## ELECTRICAL:

EMI SHIELDING : SHIELDED FOR THE RANGE  
55dB UP TO 100MHz

INSULATION RESISTANCE : >500M $\Omega$  PER ANSI-EIA-364-D METHOD 21

MAX. CURRENT RATING : (SEE TABLE 1)

CONNECTOR TESTING : 1400Vrms  
VOLTAGE TEST VOLTAGE IS APPROXIMATELY 75% OF THE DWV  
VOLTAGE AT NORMAL CLIMATIC CONDITIONS. THIS  
VOLTAGE CAN BE ACHIEVED SEVERAL TIMES, BUT NOT  
APPLIED CONTINUOUSLY.

CONNECTOR WORKING : 660/460 (Vdc/ Vrms)  
VOLTAGE WORKING VOLTAGE IS APPROXIMATELY 1/3 OF THE  
TEST VOLTAGE. THIS VOLTAGE IS SUSTAINABLE FOR  
THE LIFE OF THE CONNECTOR IN ITS WORKING  
ENVIRONMENT.

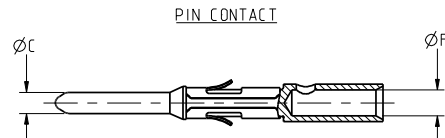

TABLE 1

TABLE 1						
CONTACT		USABLE CABLES			MAX. CURRENT RATING (A)	CONTACT RESISTANCE (mΩ)
ØC	ØF	CORE SECTION (mm <sup>2</sup> )		AWG		
		MIN.	MAX.			
0.9	1.1	0.205	0.518	20-22-24	10	3.5

DRAWING TITLE

**JBX, SIZE 0, 02 POSITION, MALE STRAIGHT PLUG**

JBXFD0G02MCSDSMR

**CUSTOMER**



**SOURIAU**  
Connection Technology

APPROVAL	DRAWN: TJS	12-18-10
	CHKD : TW	12-18-10
	DSGN : XXX	mm-dd-yy
	MFG : DH	12-18-10
	QC : DK	12-18-10

DRAWING SCALE: 5:1	
DRAWING NO.	REV

JBXFD0G02MCSDSMRC	A
-------------------	---

2 OF 2