

DO NOT
SCALE FROM
THIS PRINT

TABLE 1						
STYLE	TERMINAL	"B" POST	"L" LENGTH	-RA ONLY		
				"C"	"D"	"E"
-01	T-1S8-01-TX	.450 [11.43]	.750 [19.05]	N/R	N/R	
-02	T-1S8-02-TX	.500 [12.70]	.800 [20.32]	.100 [2.54]	.175 [4.45]	.320 [8.13] REF
-03	T-1S8-03-TX	.674 [17.12]	.955 [24.26]	** .195 [4.95]	** .156 [3.96]	** .320 [8.13] REF
-04	T-1S8-04-TX	.809 [20.55]	1.090 [27.69]	.195 [4.95]	.156 [3.96]	.534 [13.46] REF
-05	T-1S8-11-TX	.150 [3.81]	.750 [19.05]	N/R	N/R	N/R
-06	T-1S8-05-TX	1.050 [26.67]	1.350 [34.29]	N/R	N/R	N/R

**=NOT RELEASED FOR PRODUCTION.

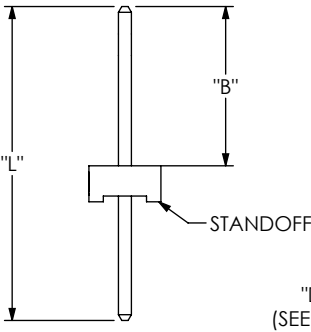
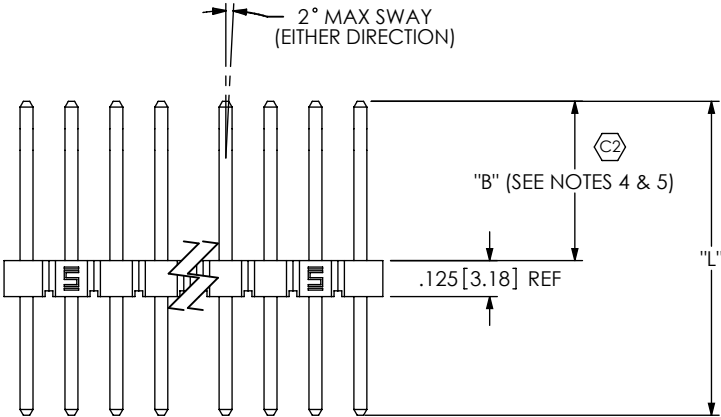
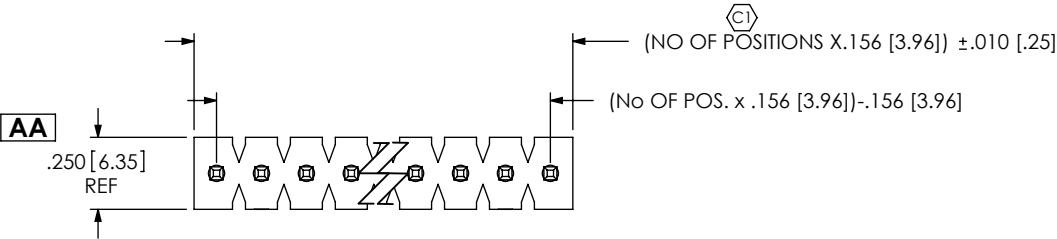

-RA
IN-PROCESS VIEW

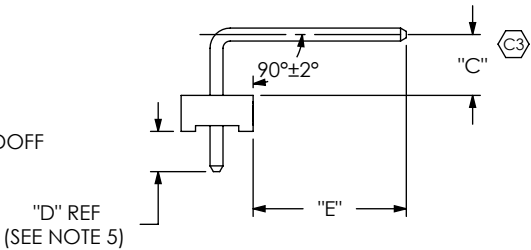
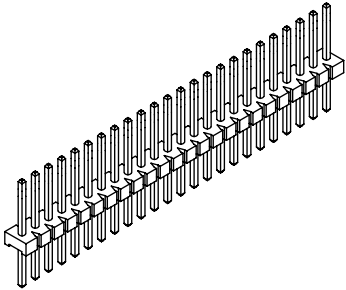

-RA
-02 & -04 ONLY

NOTES:

1. (C) REPRESENTS A CRITICAL DIMENSION.
2. MIN PUSHOUT FORCE: 3 LBS.
3. MAX ALLOWABLE BOW AFTER ASSEMBLY: .003 [.08] INCH/INCH
4. HEIGHT VARIATION BETWEEN PINS SHALL BE .005 [.13] MAX
5. BANDOLIER AREA TO BE POSITIONED ABOUT OR TOWARDS STANDOFF SIDE OF BODY. ENTIRE BANDOLIER AREA MUST NOT BE LOCATED IN THIS AREA.

UNLESS OTHERWISE SPECIFIED,
DIMENSIONS ARE IN INCHES.
TOLERANCES ARE:
DECIMALS ANGLES
.XX: ±.01 [.3] 1°
.XXX: ±.005 [.13]
.XXXX: ±.0020 [.051]

PROPRIETARY NOTE
THIS DOCUMENT CONTAINS INFORMATION
CONFIDENTIAL AND PROPRIETARY TO
SAMTEC, INC. AND SHALL NOT BE REPRODUCED
OR TRANSFERRED TO OTHER DOCUMENTS OR
DISCLOSED TO OTHERS OR USED FOR ANY
PURPOSE OTHER THAN THAT WHICH IT WAS
OBTAINED WITHOUT THE EXPRESSED WRITTEN
CONSENT OF SAMTEC, INC.

MATERIAL:
INSULATOR: PBT, UL 94 VO
COLOR: BLACK

TERMINAL: PIN STYLES -01 THRU -05: PHOS BRONZE
PIN STYLE -11: CDA 7025

c:\enterprise\dwg\MISC\MKTG\FWJ-XX-XX-TX-S-XX-MKT.SLDDRW

DO NOT SCALE DRAWING SHEET SCALE: 1.5:1

DESCRIPTION:

.045 SQ POST ASSEMBLY

DWG. NO.

FWJ-XX-XX-TX-S-XX

BY: DEAN PURVIS 2-19-86

SHEET 1 OF 1

samtec

520 PARK EAST BLVD. NEW ALBANY, IN 47150
PHONE: 812-944-6733 FAX: 812-948-5047
e-Mail: info@SAMTEC.com code 55322