

Part Number    

ERA.1S.304.CLL

Size/Series 1S / S

[Request a quote](#)

## MECHANICAL DETAILS

**Shell Style/Model** ERA\*: Fixed receptacle, nut fixing

**Keying** Hermaphroditic keying ("half moon" insert), plug has male pin 1

**Housing Material** Brass (chrome plated) shell and collet nut, nickel plated brass latch sleeve and mid pieces

**Cable Fixing**  $\varnothing$  : 0 - 0 mm

**Variant** :

	A	B	E	L	L1	M	S1	S3	e
mm.	14	16	7.5	20.2	20.5	1.5	10.5	14	M12x1.0
in.	0.55	0.63	0.30	0.80	0.81	0.06	0.41	0.55	

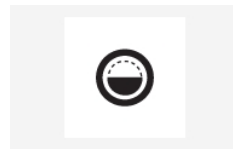
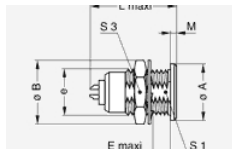
[Copyright](#) [Privacy policy](#) [Product safety](#)

## PERFORMANCE DETAILS

**Insert Configuration** 1S.304 : 4 Low Voltage

**Insulator** L: PEEK

**Vtest:** 1200 V (AC), 1800 V (DC)

**Rated Current:** 10 A (AC/DC)

## OTHER CHARACTERISTICS

**Humidity (max):** <=95% [at 60 deg C /140 F]

**Vibration:** 15 g [10 Hz - 2000 Hz]

**Shock Resistance:** 100 g [ 6 ms]

**Salt Spray Corrosion:** >144 hr

**Climatical Category:** 50/175/21

**Shielding (min):** 75 dB (10 MHz)

**Shielding (min):** 40 dB (1 GHz)

**IP Rating** 50

**Catalog**

[Download 3D draw](#)