

NOTES:

1. MATERIALS AND FINISHES:  
BODY: BRASS, GOLD PLATING  
CONTACT: BERYLLIUM COPPER, GOLD PLATING.  
INSULATOR: PTFE
2. PHYSICAL:  
A. OPERATING TEMPERATURE: -65°C to +165°C  
B. DURABILITY: 100 MATING CYCLES MINIMUM  
C. INTERFACE: PROPRIETARY AFI INTERFACE
3. ELECTRICAL:  
A. IMPEDANCE: 50 OHMS, NOMINAL  
B. FREQUENCY RANGE: 0 TO 6 GHz  
C. VSWR: 1.10 + 0.06 x F (GHz) MAX, FROM 0 TO 3 GHz  
0.56 + 0.24 x F (GHz) MAX, FROM 3 TO 6 GHz  
D. SEE 349-50861 FOR RECOMMENDED LAUNCH
4. PACKAGING:  
A. SINGLE PACK IN BAG.  
B. MARK BAG OR TAG: AMPHENOL RF  
920-264P-51P  
DATE CODE (YYWW)
5. ADD DIM "B" FROM PLUG AND DIM "A" FROM JACK  
OF TWO MATING CONNECTORS TO FIND THE  
NOMINAL BOARD-TO-BOARD SPACING.  
AXIAL FLOAT IS ±0.50 [0.020"]  
RADIAL FLOAT IS ±0.38 [0.015"]

THIRD ANGLE PROJ.

REVISIONS

REV	DESCRIPTION	DATE	ECO	APPR
A	RELEASE TO MFG.	--	49535	KR

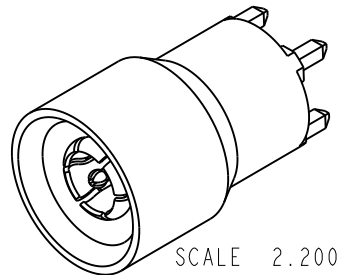

SCALE 2.200

TRACE PAD FOR SURFACE  
MOUNT CENTER CONTACT

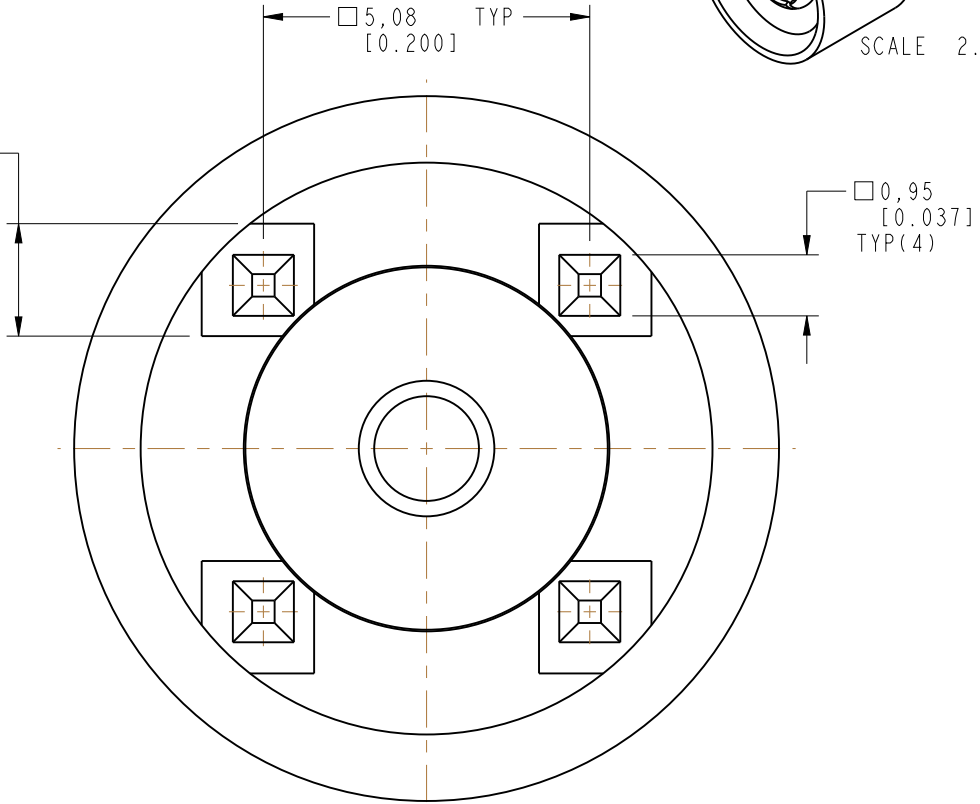
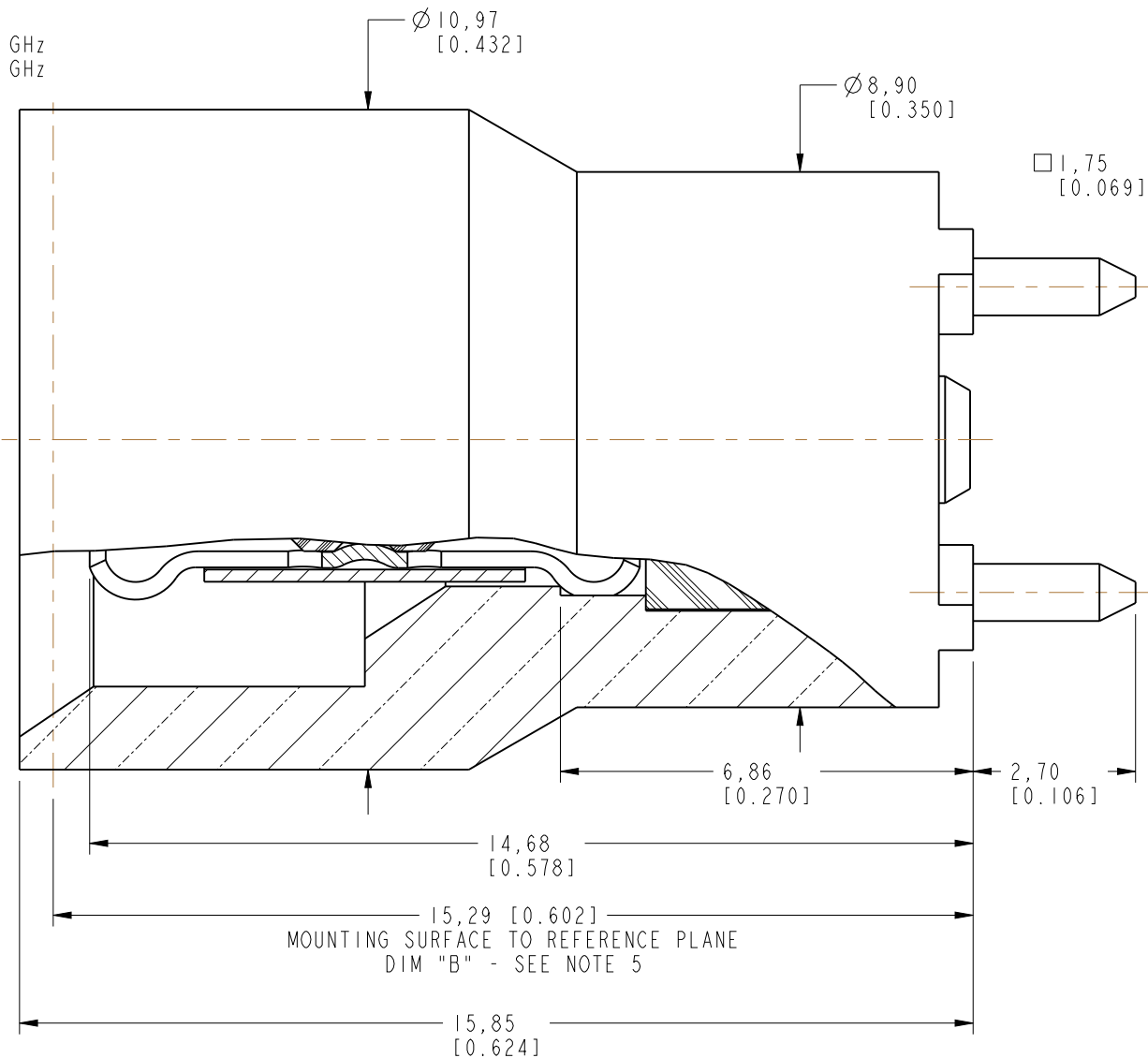
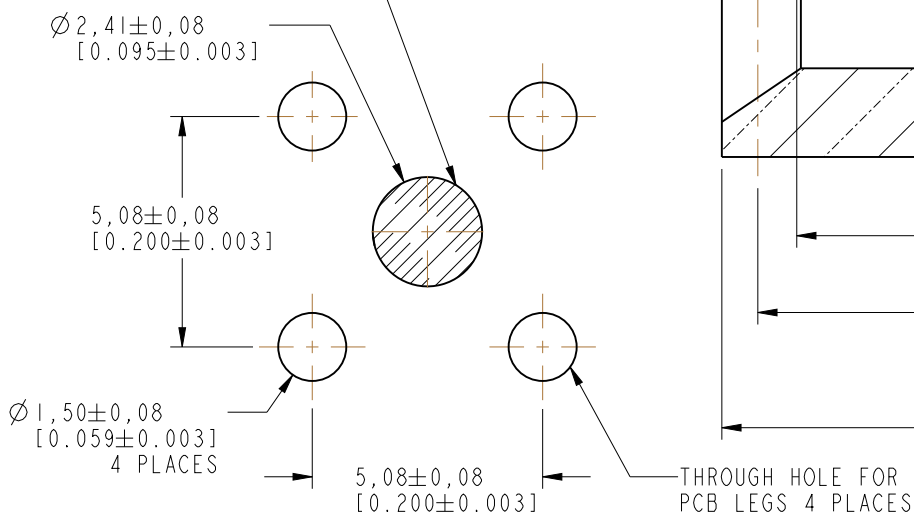

SUGGESTED  
PCB FOOTPRINT

CUSTOMER OUTLINE DRAWING  
ALL OTHER SHEETS ARE FOR INTERNAL USE ONLY

<div>UNLESS OTHERWISE SPECIFIED, DIMENSIONS ARE IN METRIC AND TOLERANCES ARE: &lt;0.5mm 0.5 - 6mm 6 - 30mm 30 - 120mm ANGLES ± 0.05mm ±0.1mm ±0.2mm ± 0.3mm ±1°</div> <div>NOTICE - These drawings, specifications, or other data (1) are, and remain the property of Amphenol corp. (2) must be returned upon request; and (3) are confidential and not to be disclosed to any person other than those to whom they are given by Amphenol Corp. the furnishing of these drawings, specifications, or other data by Amphenol Corp., or to any other person to anyone for any purpose is not to be regarded by implication or otherwise in any manner licensing, granting rights to permitting such holder or any other person to manufacture, use or sell any product, process or design, patented or otherwise, that may in any way be related to or disclosed by said drawings, specifications, or other data.</div>	MATERIAL	DRAWN	DATE	TITLE		Amphenol RF www.amphenolrf.com	
	SEE NOTES	A ARUN PRABU	05-Feb-13				
	REFERENCE	ENGINEER	DATE	AFI STR PLUG PCB MOUNT		DRAWING NO.920-264P-51P	
	EAR # 3289	T. SMITH	05-Feb-13			ITEM NO.920-264P-51P	
	CONFIGURATION LEVEL: In Work	APPROVED	DATE	SCALE: 8.5:1.0   SHEET 2 OF 2		PART NO.920-264P-51P	
	FINISH	CAD FILE		DWG SIZE B		REV A	