

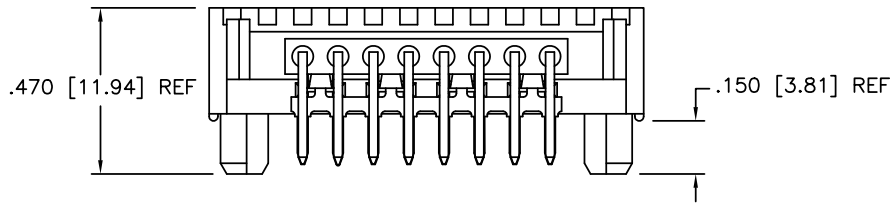

FCIconnect.com

Copyright FCI

PRODUCT NUMBER
SEE TABLE

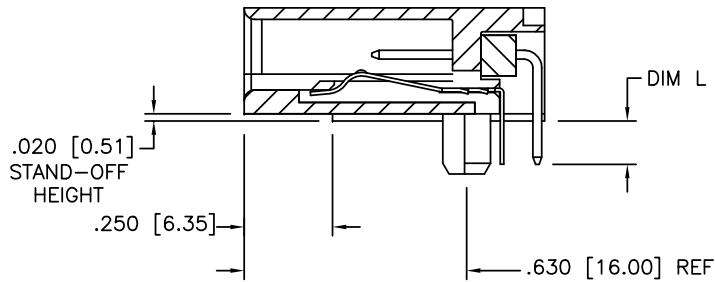
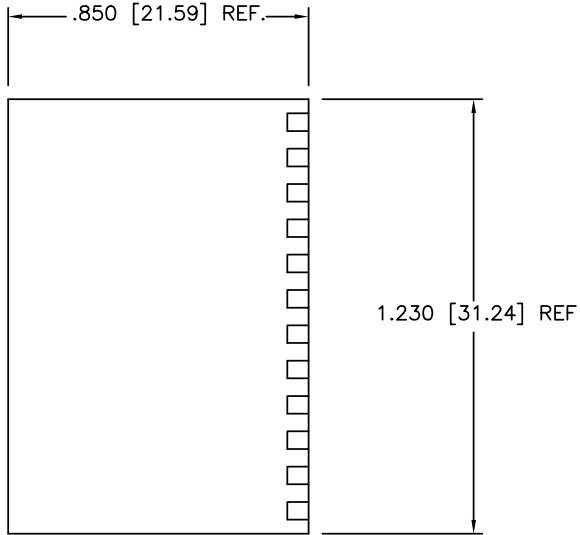

mat'l. code		surface ISO 1302 ✓		tolerance ISO 406 ISO 1101		projection INCH/MM		product family LATCH-N-LOK			
l	tr	ec	n	o	d	r	date	tolerances unless otherwise specified			
J	ELX-N-008447	ZK	11/29/11	angles	linea	.XX±.01/0.X±0.3		title			
						.XXX±.005/0.XXX±0.13		1X8 LNL RIGHT ANGLE			
						.XXX±.0020/0.XXX±0.05		HEADER ASSEMBLY			
D	M04-0230	MHT	12/8/04	0°±2°				scale 2:1			
E	M05-0052	ERE	3/19/05	dr	J. LINN	7/17/90		dwg no			
F	M06-0285	AGS	7/28/06	engr	D. HORCHLER	7/17/90		sheet 1 of 2			
G	M06-0365	AGS	9/20/06	chr	D. HORCHLER	7/17/90		69913			
H	M09-0048	MHT	3/12/09	appd	D. HORCHLER	7/17/90		type Product Customer Drawing			
sheet	revision	J	J								
index	sheet	1	2								

69913-XXXXLF

LEAD FREE OPTION ⑥ ⑦

COLOR ④	
1	70343 LT GRAY OBS
2	80166 OFF WHITE
3	70634 DK GRAY OBS
4	701 BLACK
5	70511 SLATE GRAY OBS
7	70455 SILVER GRAY
8	80189 PEARL WHITE OBS
9	70419 PEBBLE GRAY

PLATING ③	
0	30u" MIN OVER 50u"MIN Ni
3	30u" MIN OVER 50u"MIN Ni
5	50u" MIN OVER 50u"MIN Ni

PIN LENGTH	
	DIM L
0	1.50/3.18
1	.110/2.79

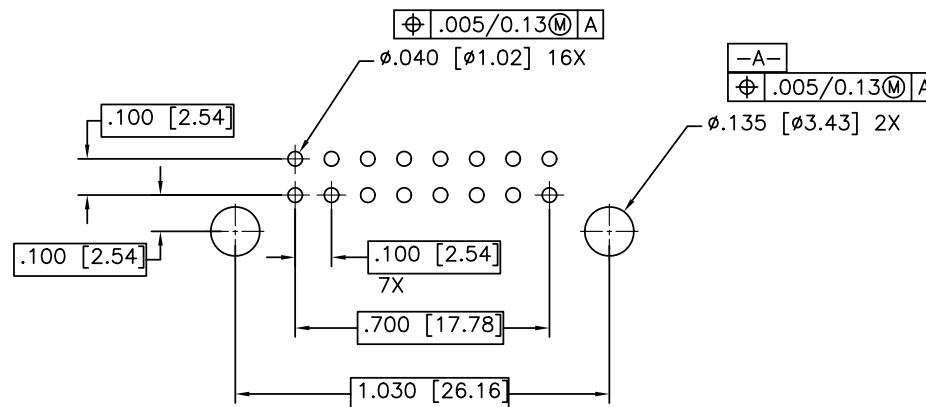

RECOMMENDED PCB LAYOUT

## NOTES:

- MAT'L: HIGH TEMPERATURE THERMOPLASTIC, UL-94V-0 RATED
- GROUND CONTACT  
MAT'L: COPPER ALLOY  
PLATING: 100-160u"/2.54-4.06u TIN.
- ③ SIGNAL CONTACT  
MAT'L: COPPER ALLOY  
PLATING: PERFORMANCE PLATING WILL BE EITHER GOLD OR GXT ON CONTACT AREA OR TAIL, OPTIONALLY (78-295u") TIN ON TAIL.
- ④ NUMBERS SHOWN ARE FOR G.E. LEXAN AND ARE FOR REFERENCE ONLY.
- THIS ASSEMBLY U.L. APPROVED PER FILE E66906 VOL. 1, SEC. 84 AND CSA APPROVED PER MASTER FILE LR46923
- ⑥ ADD LF SUFFIX AT THE END OF PART NUMBER FOR LEAD FREE OPTION.
- THE HOUSING WILL WITHSTAND EXPOSURE TO 260°C PEAK TEMPERATURE FOR 15 SECONDS IN A WAVE SOLDER APPLICATION WITH A 1.5mm MINIMUM THICK CIRCUIT BOARD. SEE APPLICATION NOTES/PROCEDURES IF THEY ARE AVAILABLE.
- THIS PRODUCT MEETS EUROPEAN UNION DIRECTIVES AND OTHER COUNTRY REGULATION AS DESCRIBED IN GS-22-008.
- PRODUCT SPEC: GS-12-003

mat'l. code	surface ISO 1302 ✓	tolerance ISO 406 ISO 1101	projection INCH/MM	product family LATCH-N-LOK
ltr ecn nodr date	tolerances unless otherwise specified	angles linea 0°±2°	scale 2:1	title 1X8 LNL RIGHT ANGLE HEADER ASSEMBLY
J	dr J. LINN 7/17/90	engr D. HORCHLER 7/17/90	chr D. HORCHLER 7/17/90	dwg no 69913 sheet 2 of 2 size A3
	app D. HORCHLER 7/17/90			type Product Customer Drawing
sheet index	revision sheet			