

REVISIONS				
REV.	ECO. NO	DESCRIPTION	DATE	BY
A	2068	INITIAL RELEASE	9/16/09	TT

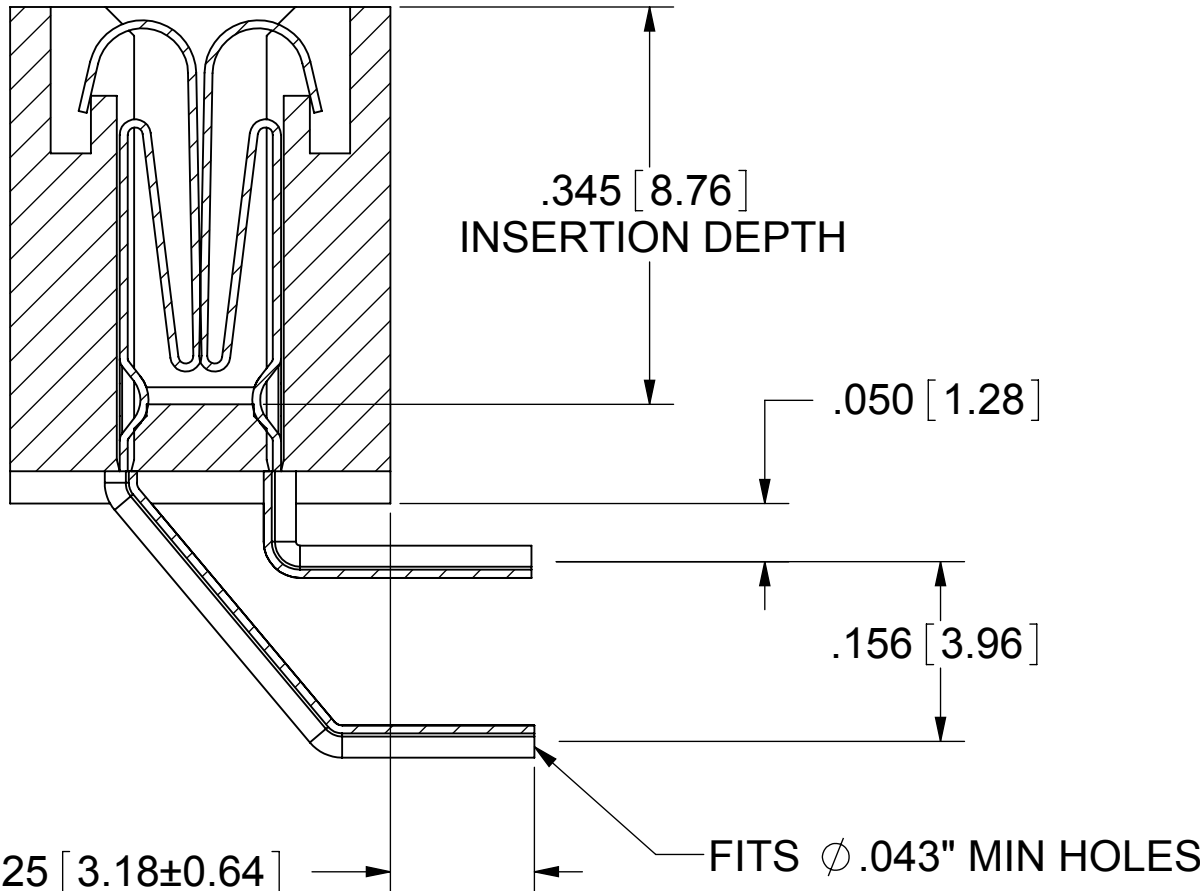
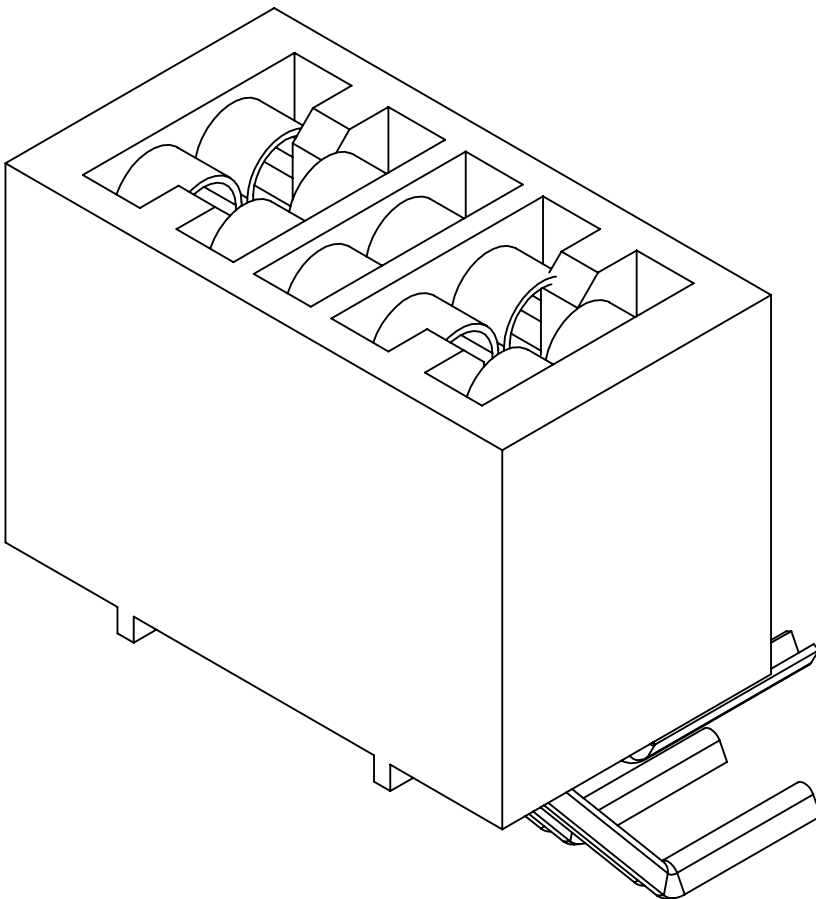

SECTION A-A  
SCALE 6 : 1

CUSTOMER COPY

- NOTES:
1. INSULATOR MATERIAL: PPS
  2. CONTACT MATERIAL: SPINODAL
  3. PLATING: .000050" NICKEL UNDERPLATE  
CONTACT: .000030" GOLD  
TERMINATION: .000010" GOLD
  4. TEMPERATURE: -65 °C TO 200 °C
  5. PROCESSING TEMP: 260 °C FOR 120 SECONDS MAX.
  6. UL FLAMMABILITY RATING: 94V-0
  7. VOLTAGE RATING: 600 VDC MINIMUM AT SEA LEVEL.
  8. CURRENT RATING: 3 AMP PER CONTACT
  9. CONTACT RESISTANCE: 30 MILLIOHMS MAX
  10. INSULATION RESISTANCE: 5000 MEGA OHM
  11. CONNECTOR IDENTIFICATION: THE PART SHALL BE MARKED WITH A PART NUMBER AND BARCODE
  12. BOARD THICKNESS ACCOMMODATED: .062 ±.008"
  13. BOARD INSERTION FORCE: 16 OZ MAX PER CONTACT PAIR WHEN USING A .062" TEST BLADE. INTERNAL INSPECTION TO BE PER SULLIN'S WORK INSTRUCTION W17.3-01.
  14. BOARD WITHDRAWAL FORCE: 1 OUNCE MINIMUM PER CONTACT PAIR USING .062" PCB
  15. MODIFICATION: SHORTING CONTACTS ALL POSITIONS. RIGHT ANGLE BEND, .156" ROW SPACING, .125" TAIL LENGTH FROM SIDE OF BODY AFTER BEND. CONTACT CENTERS .095"/.115", .345" INSERTION DEPTH

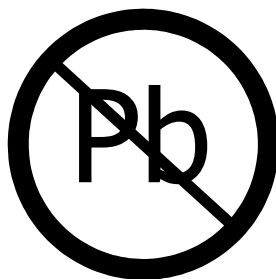

RoHS COMPLIANT

UNLESS OTHERWISE SPECIFIED:  
DIMENSIONS ARE IN INCHES[MM]  
TOLERANCES:  
ANGULAR: ± 30'  
.XX=± .02 [.508]  
.XXX=± .005 [.1270]  
.XXXX=± .0005 [.0127]  
SURFACE FINISH: 63 Rq  
REMOVE ALL BURRS AND SHARP EDGES .010 MAX

INTERPRET DIMENSIONS AND GEOMETRIC TOLERANCING PER: ANSI Y14.5M-1994

DRAWN	DATE	NAME
9/16/09	TT	

THE INFORMATION HEREIN CONTAINS PROPRIETARY INFORMATION OF SULLINS ELECTRONICS AND IS NOT TO BE REPRODUCED, USED OR DISCLOSED TO OTHERS FOR ANY PURPOSE EXCEPT AS SPECIFICALLY AUTHORIZED IN WRITING BY AN OFFICER OF SULLINS ELECTRONICS.

SULLINS CONNECTOR SOLUTIONS		
DESCRIPTION EDGE CARD RIGHT ANGLE BEND		
PART NUMBER MPP-1100-05-DS-4GR(S1402)		
SIZE C	DWG. NO. C11412	REV A
SCALE: 6:1		SHEET 1 OF 1