

Dimensions mm[inch]

tolerances acc. to DIN ISO 2768-m
 Toleranzen gem. DIN ISO 2768-m

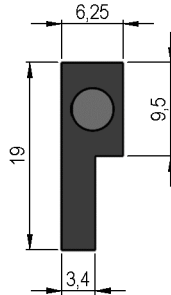
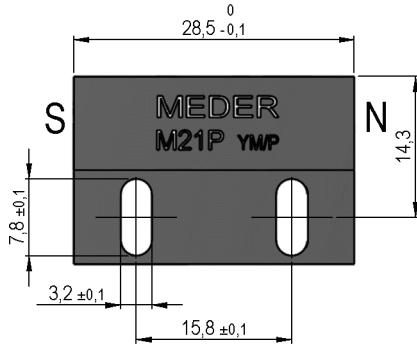

Isometric

Scale 1:1
 Maßstab 1:1

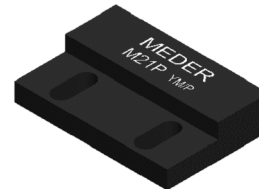

Marking

according to EN60062/factory code
 gem. EN60062/Fertigungsstätte

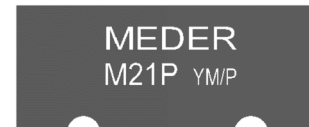

Special Product Data	Conditions	Min	Typ	Max	Unit
Sealing compound				Polyurethan	
Housing material				SK655FR1	
Case color				black	

Mag. values DIN IEC 60404-8-	Conditions	Min	Typ	Max	Unit
Magnet Material				Aluminium Nickel Cobalt	
Remanence Br		1.120	1.240		mT
Coercivity HcB		47	51,3		kA/m
Coercivity HcJ		48	51,7		kA/m
Density			7,4		g/cu cm
Max. operating temperature				450	°C
Magnetic moment	measured with MS150	19,8	22,2		E-6 Vs*cm
Magnet Material				Aluminium Nickel Cobalt	

General data	Conditions	Min	Typ	Max	Unit
Remarks				All details according to manufacturers information	
Housing Style/Form				MK21 (4005004091)	