

# Commercial MIL-DTL-5015

## Dust Caps & Rubber Bushing

- ❖ Dust cap with external thread for use with Straight Plugs (M90-3106F).
- ❖ Dust cap with internal thread for use with Cable connectors (M90-3101F) and Panel Mount connectors (M90-3102R).
- ❖ Dust caps supplied fitted with chain.
- ❖ Rubber Bushing for use with Cable connectors (M90-3101F) and Straight Plugs (M90-3106F).



### DUST CAP – EXTERNAL THREAD

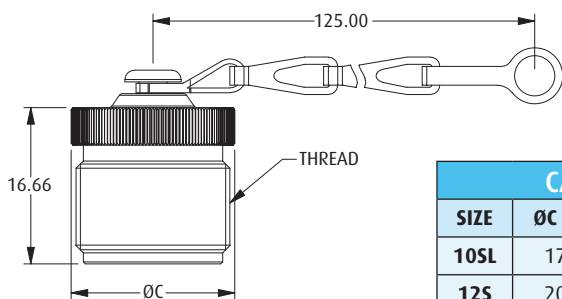

CALCULATION		
SIZE	ØC MAX	THREAD
10SL	17.45	5/8-24UNEF-2A
12S	20.62	3/4-20UNEF-2A
14S	23.8	7/8-20UNEF-2A

### RUBBER BUSHING

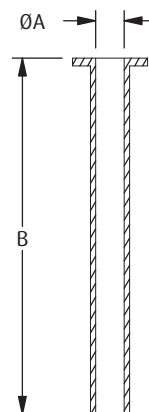

CALCULATION		
SIZE	ØA	B
4	5.59	69.85
6	7.92	66.68

### DUST CAP – INTERNAL THREAD

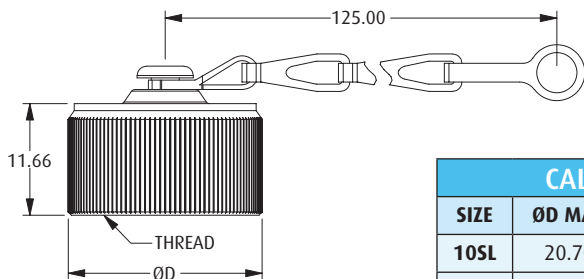

CALCULATION		
SIZE	ØD MAX	THREAD
10SL	20.70	5/8-24UNEF-2B
12S	25.40	3/4-20UNEF-2B
14S	28.58	7/8-20UNEF-2B

### HOW TO ORDER

**M90 - XXXXX - XXXX**

#### SERIES CODE

TYPE	
25042	Dust Cap – External thread
25043	Dust Cap – Internal thread
3420	Rubber Bushing

#### SIZE

10SL	For use with 10SL shell size (Dust caps)
12S	For use with 12S shell size (Dust caps)
14S	For use with 14S shell size (Dust caps)
4	For use with 10SL & 12S shell sizes (Bushing)
6	For use with 14S shell size (Bushing)

All dimensions in mm.

[www.harwin.com](http://www.harwin.com)

