

10	9	8	7	6	5	4	3	2	1
MATERIAL NO.	ALTERNATE NO.	WIRE RANGE AWG(mm2)	HOUSING COLOR						
192160011	WT-2218	22-18(.34-.75)	RED						
192160010	WT-1814	18-14(.75-2.5)	BLUE						
192160009	WT-12	12(4.0)	YELLOW						

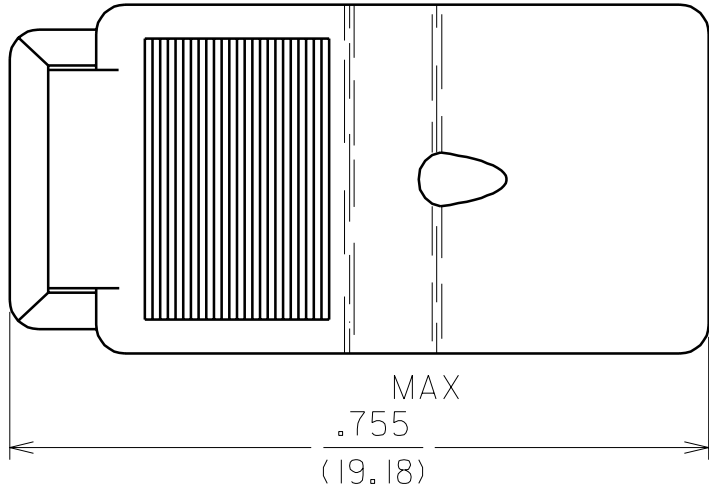

INSULATION HOUSING SUPPORT RIBS

ASSEMBLED ON WIRE

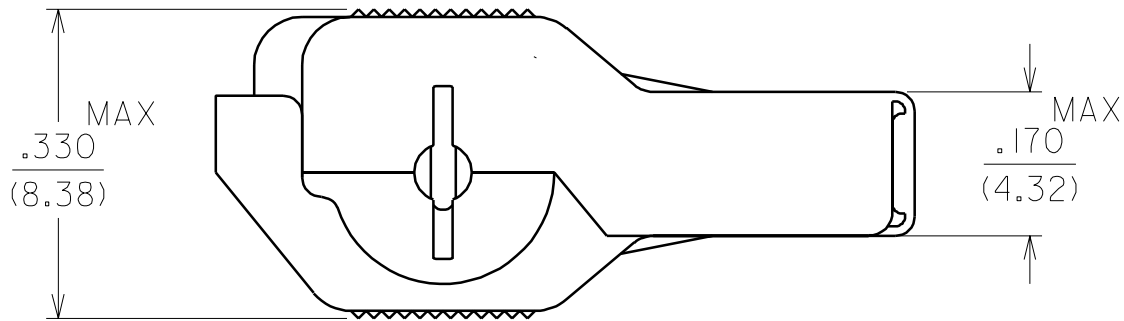
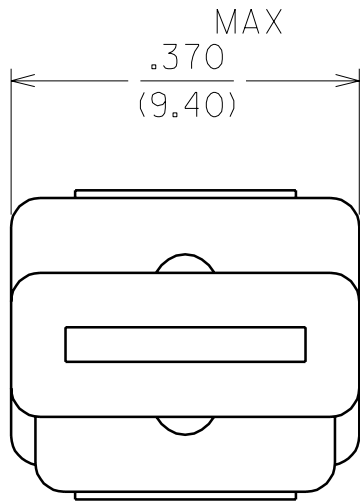
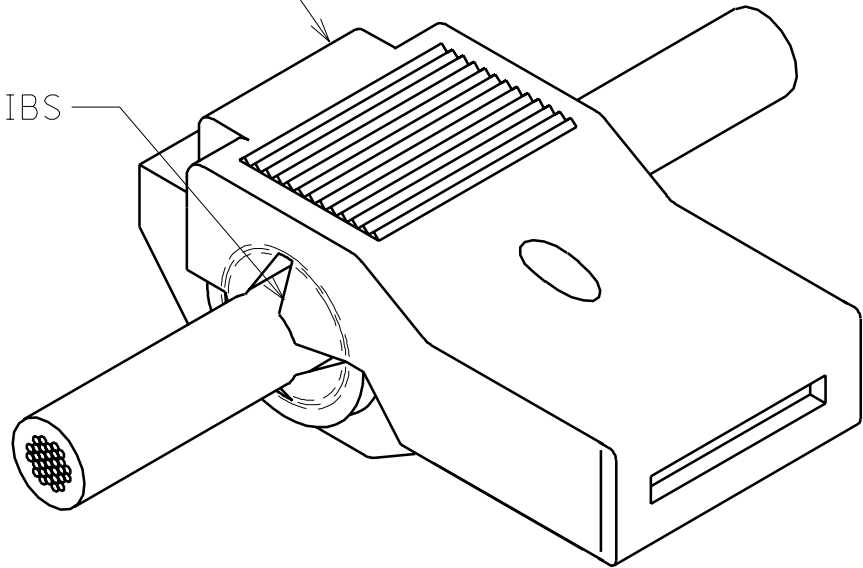

NOTES:

1. MATERIALS

HOUSING: UNFILLED NYLON UL FLAMMABILITY

RATING 94V-2

COLOR: SEE TABLE

TERMINAL: COPPER ALLOY

2. FINISH

TERMINAL: TIN

CLOSED POSITION AFTER ASSEMBLY ON WIRE

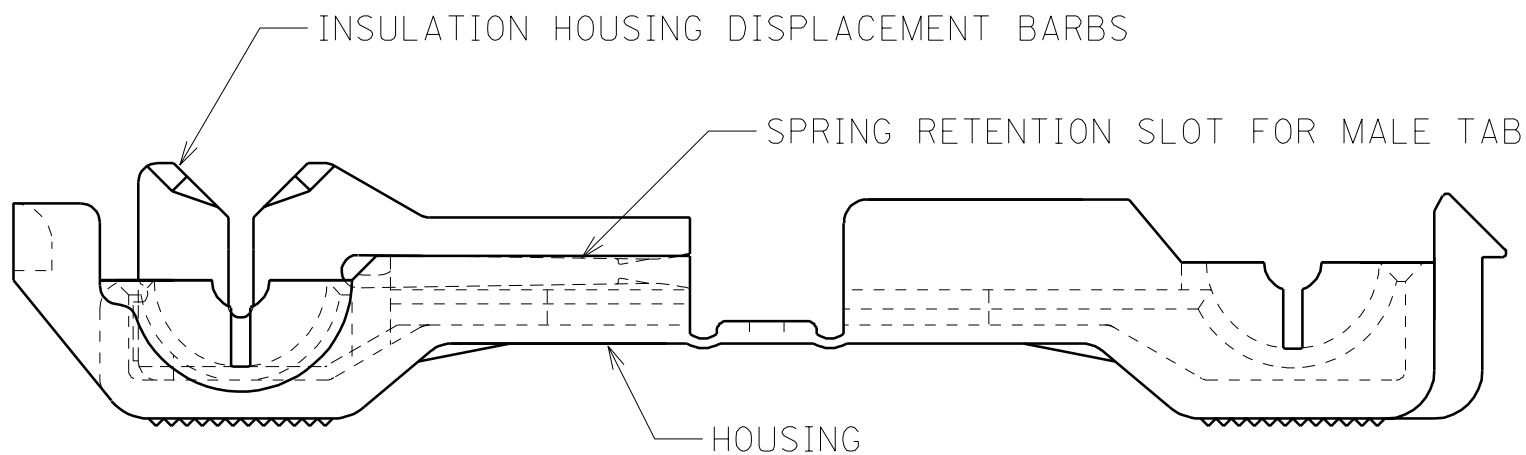

OPEN POSITION PRIOR TO ASSEMBLY ON WIRE

CUSTOMER DRAWING

DIMENSIONS SHOWN (METRIC) INCH				REVISE ONLY ON CAD SYSTEM			
UNLESS OTHERWISE SPECIFIED TOLERANCES: ANGULAR $\pm 1/2^\circ$				TITLE WIRE TAP MULTIMATE			
		INCH	METRIC	molex ETC INC. PINELLAS PARK, FLA. 33781 U.S.A.		SHEET NO. 1 OF 1	DATE 09/07/94
3 PLACE	$\pm .005$	$\pm ---$		PART NO. SEE TABLE		DRWG. NO. SD-19216-001	
2 PLACE	$\pm .01$	$\pm 0.13$		FILE NAME 19216001 SD		THIS DRAWING CONTAINS INFORMATION THAT IS PROPRIETARY TO MOLEX-ETC INC. AND SHOULD NOT BE USED WITHOUT WRITTEN PERMISSION.	
1 PLACE	$\pm ---$	$\pm 0.25$		APP'D. BY FP		DIV. ETC	
DRWG. BY RCM		CHK'D. BY JM		SCALE 5: 1		SIZE B	



# ENGINEERING SPECIFICATION

## INSTALLATION INSTRUCTION SHEETS

### 1.0 SCOPE

This specification consists of installation instructions for wire taps.

### 2.0 PURPOSE

To clarify installation instructions for end users of wire taps.

### 3.0 REFERENCE MATERIAL NUMBERS

See page 2 for the actual instruction sheets. This page can be used as originals when cut into fourths.

### 4.0 DEFINITIONS

Not applicable.

### 5.0 PROCEDURES

Place one (1) instruction sheet (1/4 of next sheet) in the smallest unit container.

### 6.0 IMPLEMENTATION

August 10, 2010

REVISION:	ECR/ECN INFORMATION:	TITLE:	SHEET No.
<b>A</b>	EC No: <b>WNA2011-0136</b> DATE: <b>2010 / 08 / 10</b>	WIRE TAP INSTALLATION INSTRUCTIONS 22 THROUGH 12 AWG WIRE	<b>1 of 2</b>
DOCUMENT NUMBER:	CREATED / REVISED BY:	CHECKED BY:	APPROVED BY:
<b>SD-19216-008</b>	<b>ETHRODAHL</b>	<b>JMACNEIL</b>	<b>JMACNEIL</b>

## Assembly Instructions for Wire Tap Splices

Engineering P/N	Wire Range
WT-2218	22-18 AWG
WT-1814	18-14 AWG
WT-12	12 AWG

For use with only stranded copper wire and copper alloy tabs 600V, 105°C

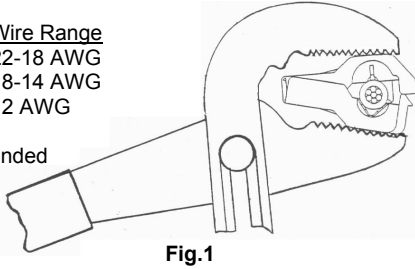

**Fig.1**

For 22-16 AWG wires, refer to Fig. 1

1. Insert the correct size wire properly into the connector.
2. Position the connector into the tongue-and-groove pliers as shown and carefully squeeze until the latch engages.

For 14-12 AWG wires, refer to Fig. 2, 3, and 1.

1. Bend the wire support membranes outward with wire (Fig.2)
2. Place the correct size wire into the nest of the metal and gently squeeze the wire into position with tongue-and-groove pliers without distorting (flattening) the wire insulation (Fig.3).
3. Position the connector into the tongue-and-groove pliers as shown and carefully squeeze until the latch engages (Fig.1).

**Fig. 2**

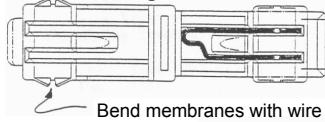

Bend membranes with wire

**Fig. 3**

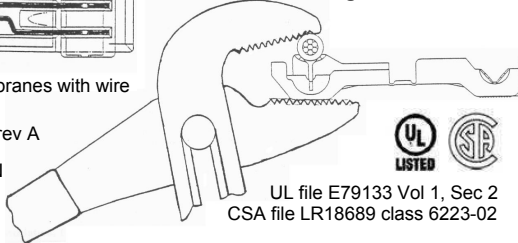

Lit p/n 192160127, rev A

4650 62nd Avenue N  
Pinellas Park, FL  
33781

UL file E79133 Vol 1, Sec 2  
CSA file LR18689 class 6223-02

## Assembly Instructions for Wire Tap Splices

Engineering P/N	Wire Range
WT-2218	22-18 AWG
WT-1814	18-14 AWG
WT-12	12 AWG

For use with only stranded copper wire and copper alloy tabs 600V, 105°C

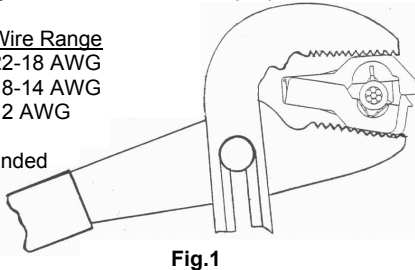

**Fig.1**

For 22-16 AWG wires, refer to Fig. 1

1. Insert the correct size wire properly into the connector.
2. Position the connector into the tongue-and-groove pliers as shown and carefully squeeze until the latch engages.

For 14-12 AWG wires, refer to Fig. 2, 3, and 1.

1. Bend the wire support membranes outward with wire (Fig.2)
2. Place the correct size wire into the nest of the metal and gently squeeze the wire into position with tongue-and-groove pliers without distorting (flattening) the wire insulation (Fig.3).
3. Position the connector into the tongue-and-groove pliers as shown and carefully squeeze until the latch engages (Fig.1).

**Fig. 2**

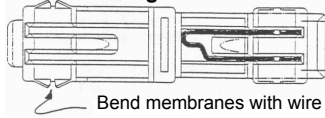

Bend membranes with wire

**Fig. 3**

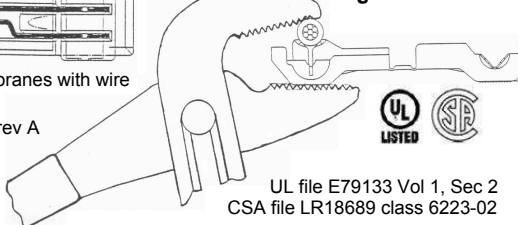

Lit p/n 192160127, rev A

4650 62<sup>nd</sup> Avenue N  
Pinellas Park, FL  
33781

UL file E79133 Vol 1, Sec 2  
CSA file LR18689 class 6223-02

## Assembly Instructions for Wire Tap Splices

Engineering P/N	Wire Range
WT-2218	22-18 AWG
WT-1814	18-14 AWG
WT-12	12 AWG

For use with only stranded copper wire and copper alloy tabs 600V, 105°C

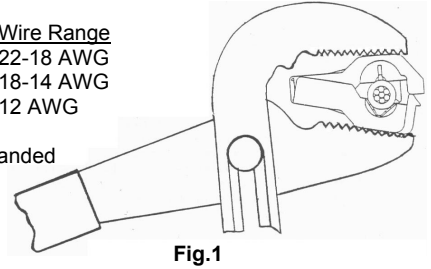

**Fig.1**

For 22-16 AWG wires, refer to Fig. 1

1. Insert the correct size wire properly into the connector.
2. Position the connector into the tongue-and-groove pliers as shown and carefully squeeze until the latch engages.

For 14-12 AWG wires, refer to Fig. 2, 3, and 1.

1. Bend the wire support membranes outward with wire (Fig.2)
2. Place the correct size wire into the nest of the metal and gently squeeze the wire into position with tongue-and-groove pliers without distorting (flattening) the wire insulation (Fig.3).
3. Position the connector into the tongue-and-groove pliers as shown and carefully squeeze until the latch engages (Fig.1).

**Fig. 2**

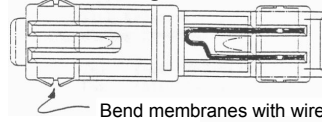

Bend membranes with wire

**Fig. 3**

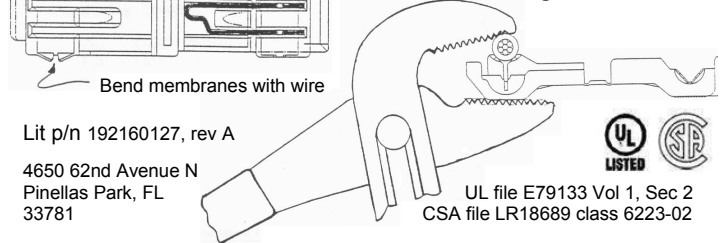

Lit p/n 192160127, rev A

4650 62nd Avenue N  
Pinellas Park, FL  
33781

UL file E79133 Vol 1, Sec 2  
CSA file LR18689 class 6223-02

## Assembly Instructions for Wire Tap Splices

Engineering P/N	Wire Range
WT-2218	22-18 AWG
WT-1814	18-14 AWG
WT-12	12 AWG

For use with only stranded copper wire and copper alloy tabs 600V, 105°C

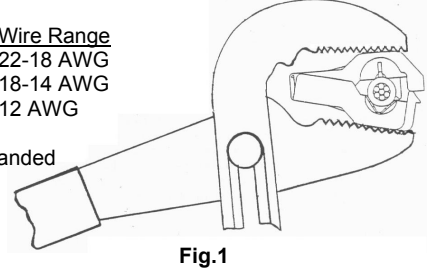

**Fig.1**

For 22-16 AWG wires, refer to Fig. 1

1. Insert the correct size wire properly into the connector.
2. Position the connector into the tongue-and-groove pliers as shown and carefully squeeze until the latch engages.

For 14-12 AWG wires, refer to Fig. 2, 3, and 1.

1. Bend the wire support membranes outward with wire (Fig.2)
2. Place the correct size wire into the nest of the metal and gently squeeze the wire into position with tongue-and-groove pliers without distorting (flattening) the wire insulation (Fig.3).
3. Position the connector into the tongue-and-groove pliers as shown and carefully squeeze until the latch engages (Fig.1).

**Fig. 2**

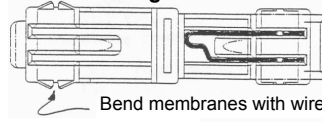

Bend membranes with wire

**Fig. 3**

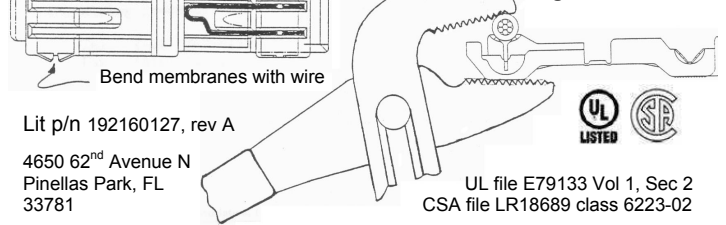

Lit p/n 192160127, rev A

4650 62<sup>nd</sup> Avenue N  
Pinellas Park, FL  
33781

UL file E79133 Vol 1, Sec 2  
CSA file LR18689 class 6223-02