

SECTION X-X

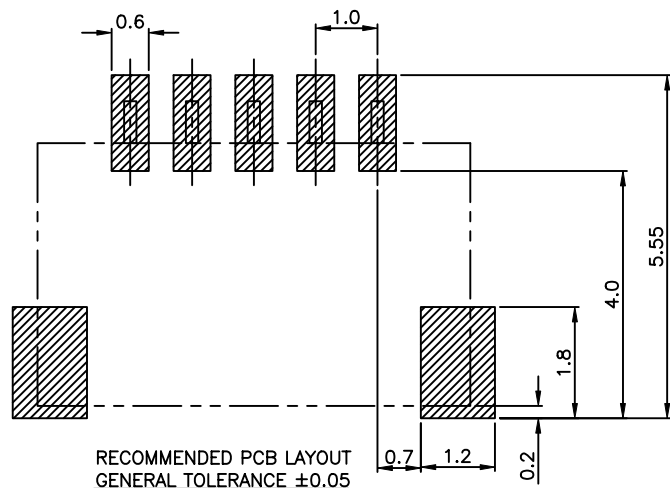
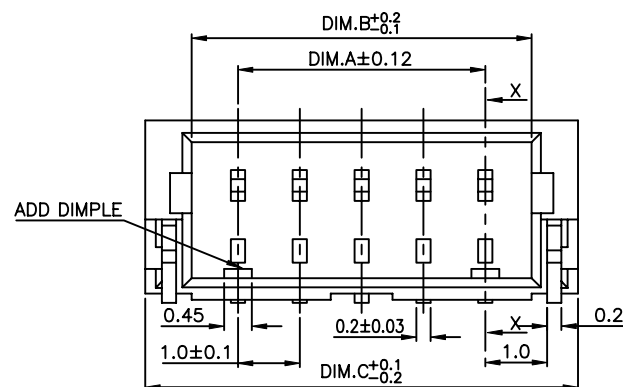
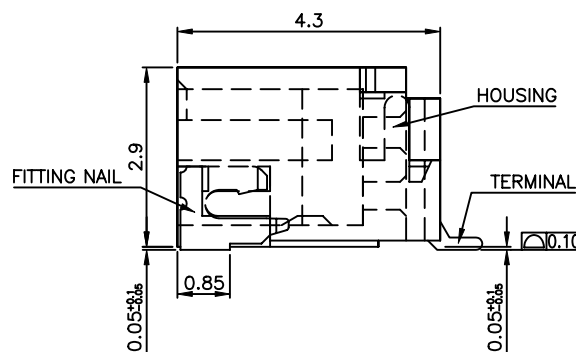

NOTES:

1. MATERIAL:

HOUSING: HALOGEN FREE HIGH TEMPERATURE
THERMOPLASTIC, UL94V-0.

TERMINAL: COPPER ALLOY.
FITTING NAIL: COPPER ALLOY.

2. FINISH:

UNDER PLATING: 30~60u" NICKEL OVERALL.
CONTACT AREA, SOLDER TAIL AND FITTING NAIL:
SELECTIVE GOLD PLATED OVERALL(SEE P/N DESCRIPTION).

3. REFLOW SOLDER CAPABLE TO 260°C PEAK TEMP.
FOR 10 SECONDS MAX.

4. SPEC. PLS. REFER TO GS-12-0930.

5. PACKAGE PLS. REFER TO GS-14-2103.

6. PART NUMBER DESCRIPTION:

10116782-XXX X X X LF

NO OF CONTACTS(CKT)

PACKING
0: TAPE & REEL

LEAD FREE
COLOR
0: BLACK

PLATING
1: 1u" MIN. GOLD FLASH OVERALL
(TERMINAL AND FITTING NAIL)

ORDERING INFORMATION FOR USER REFERENCE

NAME	PART NO.
BOARD CONN.	10116782-XXXXXXLF
CABLE CONN.	10116783-XXXXXXLF
	10116784-XXX

CKT	Dim.A	Dim.B	Dim.C	Dim.D	CKT	Dim.A	Dim.B	Dim.C	Dim.D
002	1.0	2.4	4.0	0.20	012	11.0	12.4	14.0	0.15
003	2.0	3.4	5.0		013	12.0	13.4	15.0	
004	3.0	4.4	6.0		014	13.0	14.4	16.0	
005	4.0	5.4	7.0		015	14.0	15.4	17.0	
006	5.0	6.4	8.0		016	15.0	16.4	18.0	
007	6.0	7.4	9.0		017	16.0	17.4	19.0	
008	7.0	8.4	10.0	0.15	018	17.0	18.4	20.0	
009	8.0	9.4	11.0		019	18.0	19.4	21.0	
010	9.0	10.4	12.0		020	19.0	20.4	22.0	
011	10.0	11.4	13.0		022	21.0	22.4	24.0	

mat'l. code	surface	tolerance	projection	product family
	ASME Y14.5	ASME Y14.5		WTB
ltr	ecn	no	dr	date
A		WL	05/11/11	
angles	tolerances	unless	otherwise	specified
	.X ± 0.25			
	.XX ± 0.15			
	.XXX ± 0.10			
dr	WENDY CHEN	03/11/11		
enr	WENDY CHEN	03/11/11		
chr	WENDY CHEN	03/11/11		
appd	GARY HSIEH	03/11/11		
sheet	revision	A		
index	sheet	1		
title	1.0mm WTB CONN. SMT R/A S/R TYPE			
dwg no	sheet	1 of 1	size	
10116782			A4	
type	CUSTOMER Drawing			