

PRODUCT NUMBER  
10075025-X01-XXXLF

## PLATING

S = 0.38μm GOLD/GXT ON CONTACT AREA  
2μm MIN MATTE TIN ON TAIL  
OVER 1.27μm MIN NICKELG = 0.76μm GOLD/GXT ON CONTACT AREA  
2μm MIN MATTE TIN ON TAIL  
OVER 1.27μm MIN NICKELF = GOLD FLASH ON CONTACT AREA  
2μm MIN MATTE TIN ON TAIL  
OVER 1.27μm MIN NICKELLEAD FREE  
RoHS COMPATIBLE  
NOTE 6PACKAGING  
NOTE 5TOTAL NUMBER OF  
POSITIONS, 04 TO 50

## NOTES:

1. MATERIAL HOUSING: HIGH TEMP. THERMOPLASTIC  
UL 94V-0, COLOR BLACK
2. MATERIAL TERMINAL: COPPER ALLOY
3. TO DETERMINE DIMENSIONS:  
N = NUMBER OF POSITIONS PER ROW
4. 7N MIN. PIN RETENTION IN EITHER DIRECTION.
5. PACKAGING:  
= PLASTIC BOX  
U = TUBE AVAILABLE FROM 03 TO 25 POS PER ROW  
A = TAPE & REEL WITH PICK UP CAP INSTALLED  
SEE TA-884 FOR PRODUCT AVAILABILITY
6. RoHS COMPATIBLE PRODUCT SPECIFICATIONS
  - a - PLATING:
    - "LF" MEANS THE PRODUCT IS LEAD-FREE,  
2μm MINIMUM MATTE TIN OVER 1.27μm  
MINIMUM NICKEL UNDERPLATE.
  - b - MANUFACTURING PROCESS COMPATIBILITY
    - THE HOUSING WILL WITHSTAND EXPOSURE TO  
260°C PEAK TEMPERATURE FOR 30 SECONDS MAX  
IN A CONVECTION, INFRA-RED, OR VAPOR PHASE  
OR REFLOW OVEN
  - c - LABELLING:
    - MEETS PACKAGING SPECS AS PER GS-14-920
  - d - LEGAL STATEMENT: SEE GS-22-008

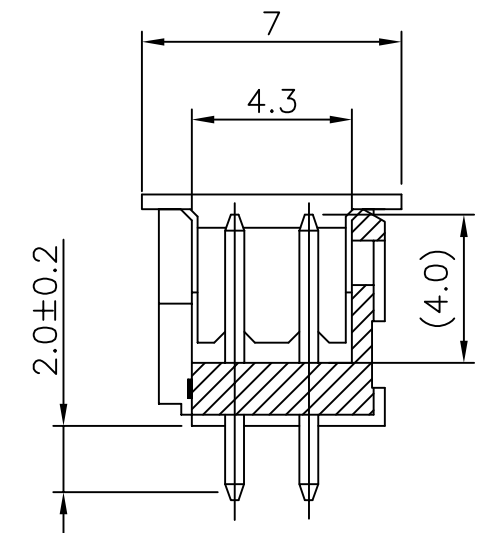
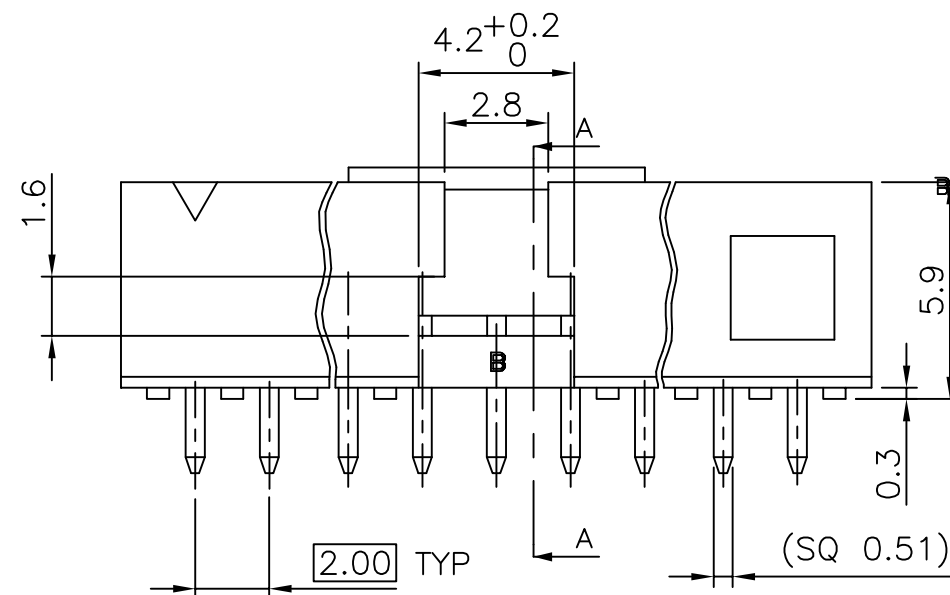
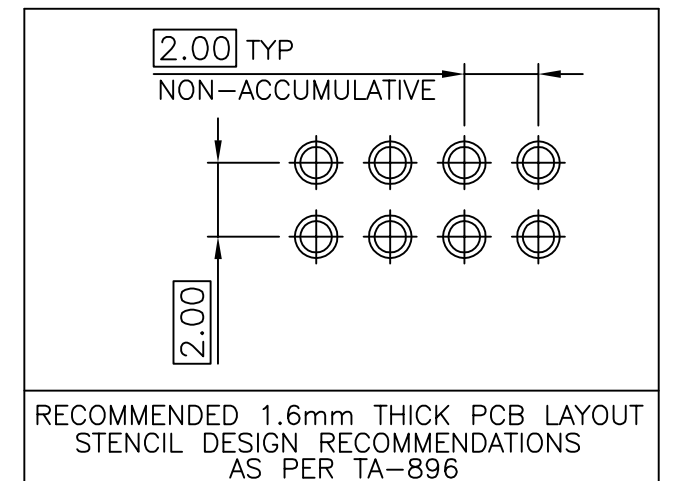
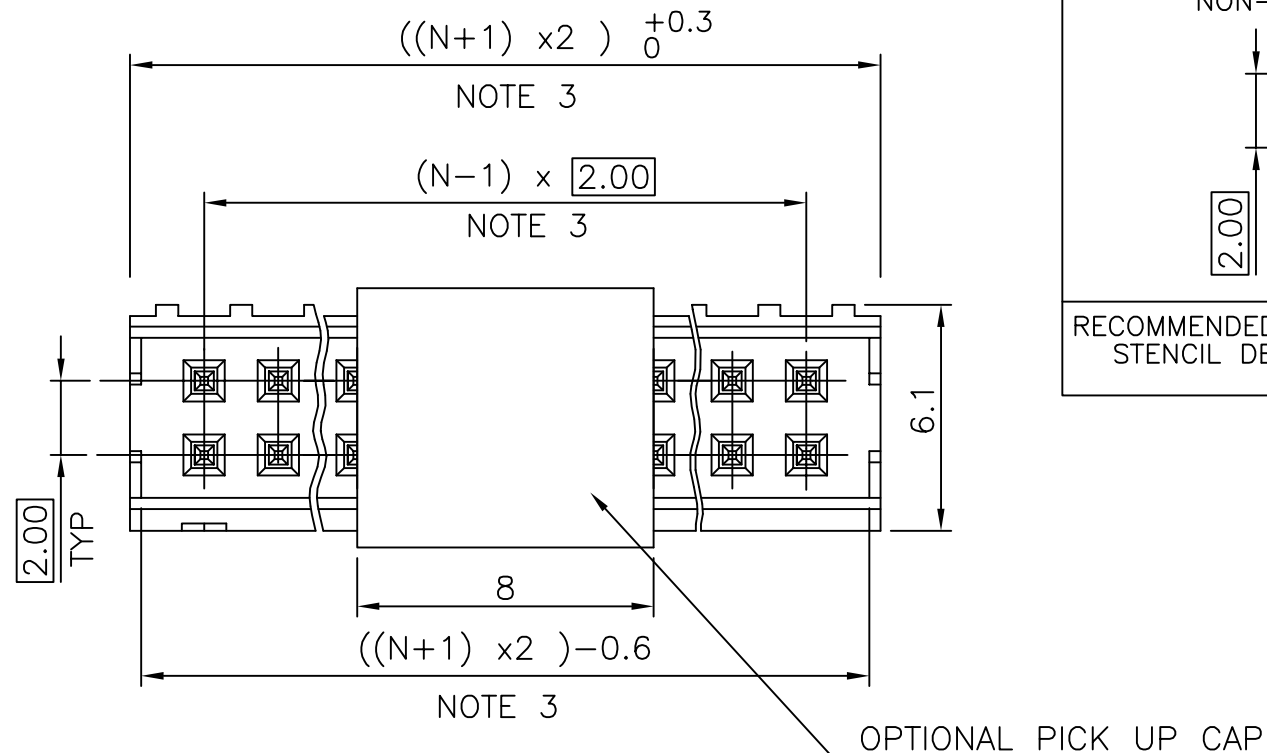

SECTION A-A

mat'l. code				surface			tolerance		projection	product family		
				ISO 1302	ISO 406	ISO	ISO 1302	ISO 406		MINITEK		
ltr	ecn no	dr	date	tolerances	unless	otherwise specified	angles	linear	mm	title		
A	F06-0326	LMU	07.01.04					.X ±0.3		SHR HEADER		
B	F07-0129	LMU	07.02.13					.XX ±0.13		2.00 mm VERTICAL PIP		
C	F08-0113	LMU	08.01.17					.XXX ±0.05				
D	F08-0145	ELA	15.04.08	dr	L.MULIN	07.01.04			scale 1:1	dwg no		
E	F08-0222	LMU	08.09.15	engr	J.COMPAGNON	07.01.04				sheet 1 of 2		
				chr						10075025		
				appd	JM.C	07.01.04				type		
										CUSTOMER Drawing		
sheet	revision	E	A									
index	sheet	1	2									

LATCHING FEATURES WHEN USED IN COMBINATION  
WITH ACTIVE LATCH HOUSING 10073599

2x3 POS AND 2x4 POS CONFIGURATION  
NO LATCHING AVAILABLE FOR 2x2 POS

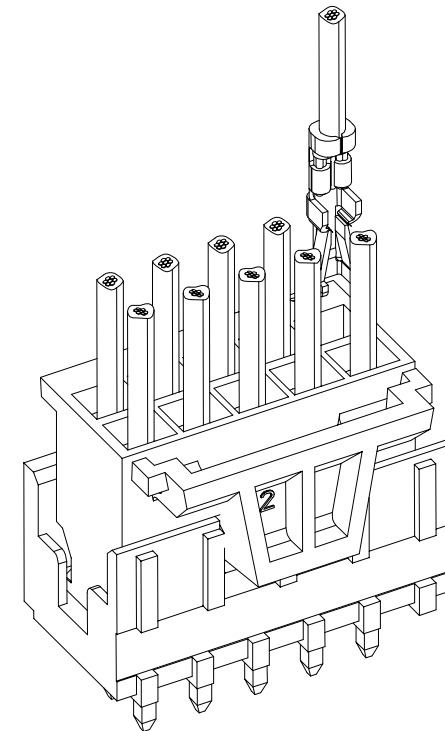
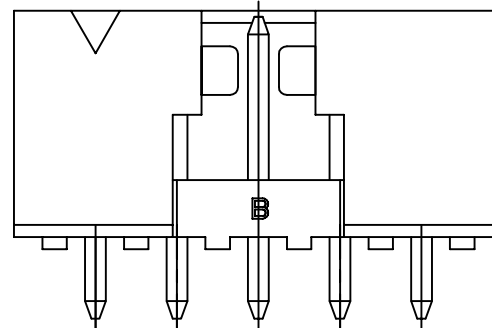
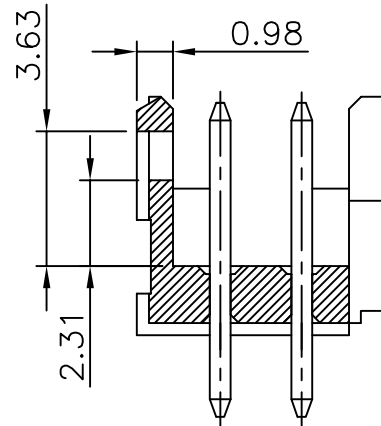
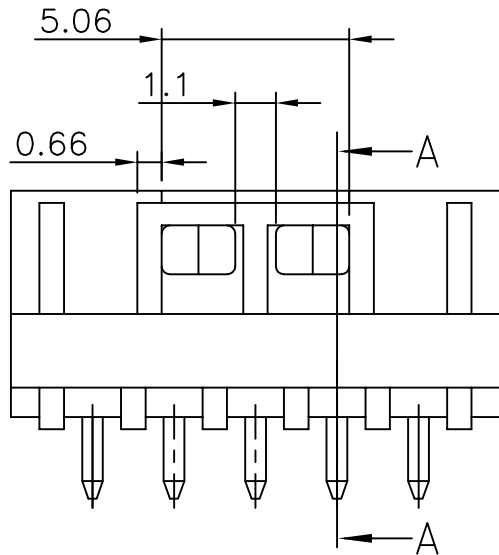
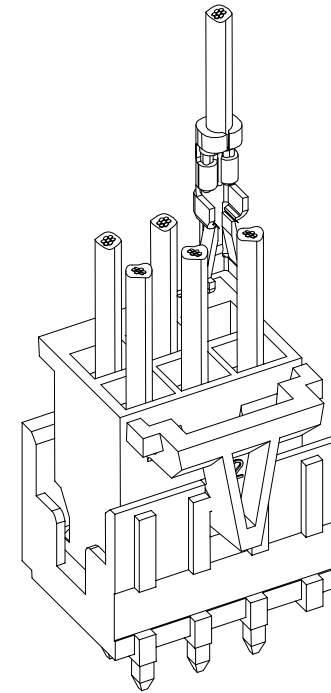
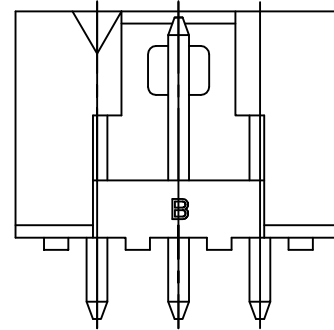
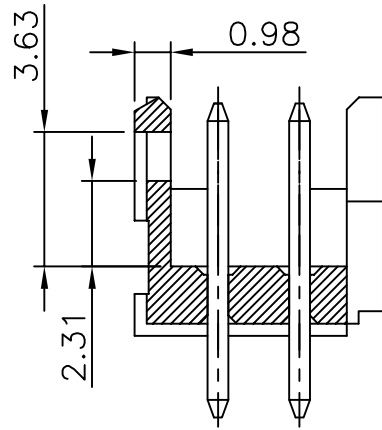
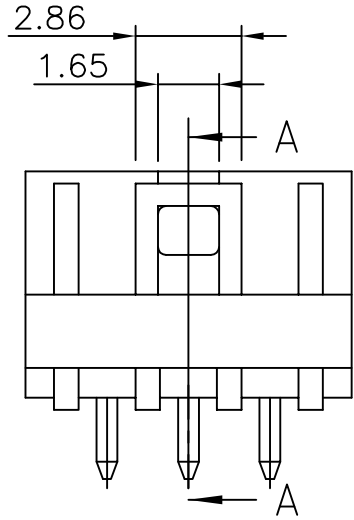

2x5 POS UP TO 2x25 POS CONFIGURATION

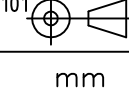
mat'l. code				surface	tolerance	projection	product family			
				ISO 1302	ISO 406	ISO 1101	MINITEK			
ltr	ecn no	dr	date	tolerances unless otherwise specified		 mm scale 1:1	title			
A	F08-0113	LMU	08.01.17	angles	linear		SHR HEADER			
							2.00 mm VERTICAL PIP			
					.X	±0.3	dwg no		sheet 2 of	size
					.XX	±0.13	10075025			A3
					.XXX	±0.05	type		CUSTOMER Drawing	
sheet index		revision sheet								