

## PACKAGING

PACKAGING TYPE:  
Tape and ReelREEL QUANTITY:  
900 Pieces

## SCHEMATIC

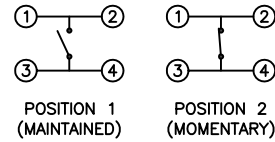

## SPECIFICATIONS

FUNCTION:  
1P1T OFF-(ON), WashableRATINGS:  
50mA 12VDCOPERATING FORCE:  
260±70gfTRAVEL:  
0.018±0.008 [0.45±0.2]CONTACT RESISTANCE:  
Initial: 100mΩ Max.INSULATION RESISTANCE:  
100MΩ Min. at 500VDCDIELECTRIC STRENGTH:  
250VAC For 1 MinuteELECTRICAL LIFE:  
500,000 CyclesSHOCK RESISTANCE:  
Mil-Std. 202F, Method 213BVIBRATION RESISTANCE:  
Mil-Std. 202F, Method 201ATEMPERATURE:  
Operating: -25°C to 70°C  
Storage: -30°C to 80°C

APPROVALS:

**RoHS LEAD FREE**  
COMPLIANT PROCESS COMPATIBLE

## COLORS

ACTUATOR:  
Red

## MATERIALS

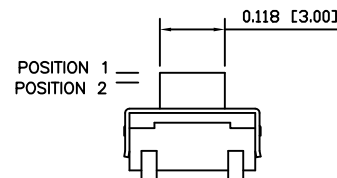
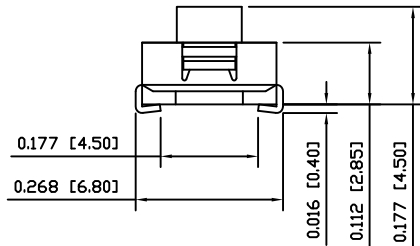
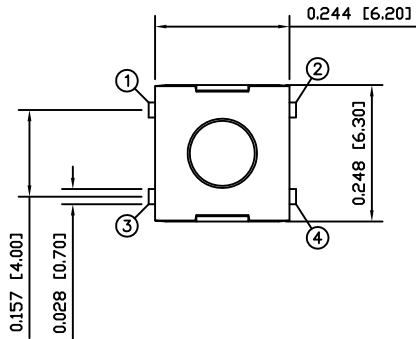
BASE:  
Nylon Thermoplastic, UL94 V-0COVER:  
Stainless SteelACTUATOR:  
Silicone RubberCONTACTS:  
Silver Clad Stainless SteelTERMINALS:  
Silver Plated Brass

## SUGGESTED PCB LAYOUT

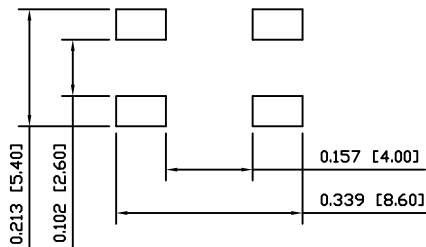

BODY	B	10/05/18	CAB
COLORS	A	09/09/10	CAB
MATERIALS	B	10/05/18	CAB
PACKAGING	A	09/09/10	CAB
SPECIFICATIONS	A	09/09/10	CAB
REFERENCE	REV.	DATE	BY

THE INFORMATION CONTAINED IN THIS DOCUMENT IS PROPRIETARY TO E-SWITCH AND IS  
NOT TO BE COPIED OR TRANSFERREDA  
REV.INITIAL RELEASE  
DESCRIPTION19066  
PCR10/05/18  
DATECAB  
DRAWN BY

DIMENSIONS	INCHES [MILLIMETERS]
GENERAL TOLERANCES	±0.008 [±0.2] / ±1°
SCALE	DRAWING NOT TO SCALE
PROJECTION	

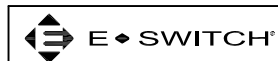

TSJW-4.5-260-TR

DRAWING NUMBER

06-TSJW45260TR

DATE

MAY 18, 2010

REVISION

A